



STATE BANK OF INDIA

INVITES E-TENDER FOR

**PROPOSED INTERIOR WORK FOR SBI SME NASHIK BRANCH, BSNL MICO CIRCLE,
CITY: NASHIK, DIST: NASHIK**

FROM

**THE FURNISHING CONTRACTORS EMPANELLED FOR MAHARASHTRA CIRCLE UNDER
THE**

IE, ID, IC, IB & IA CATEGORY OF (FROM UP TO 25 LAKH AND ABOVE UP TO 500 LAKH)

TENDER ID MAHNSK202403

THE LAST DATE OF SUBMISSION OF ONLINE TECHNICAL BID & PRICE BID: **12.04.2024
UP TO 03:00 PM**

(NO PHYSICAL SUBMISSION OF TENDER DOCUMENTS REQUIRED)

PART – A: TECHNICAL BID

TENDER SUBMITTED BY:

NAME :

ADDRESS :

DATE :

Architect : Rupali Vivek Jaykhedkar
46/B, Shivprasad, Old Pandit Colony,
Nashik-422002, Maharashtra, India.
Ph:+91 253 2575130(off), 2306311(fax)
M:9552581530

NOTICE INVITING TENDERS

SBI invites E Tender for Interior Furnishing works for shifting of SBI SME Nashik Branch, Dist: Nashik (Bidders has to submit his final Online quote) from the SBI Empanelled Furniture contractors of Maharashtra Circle.

The details of tender are as under:

S.No.	Description																			
1.	Name of work	INTERIOR WORKS OF SBI SME NASHIK BRANCH, DIST:NASHIK																		
2.	Nature of Work	INTERIOR FURNISHING WORK																		
3.	Time allowed for completion	45 Days from date of acceptance of work order.																		
4.	Earnest Money Deposit	Rs. 22,700.00/- (Rupees Twenty Two Thousand Seven Hundred Only) by means of Demand Draft / Pay Order (Valid for a period of 90 Days from the last date of submission of the tender) from any scheduled Nationalized Bank drawn in favour of State Bank of India payable at Nashik. EMD in the form of Cheque will not be accepted. Tender will be rejected if EMD not submitted in hard copy.																		
5.	Initial Security Deposit	2 % of contract amount including EMD																		
6.	Total Security deposit	5 % of the final bill amount including ISD																		
7.	Start and end date for downloading of tender documents form Bank's website	30-03-2024 to 12-04-2024 at www.sbi.co.in or https://bank.sbi under In the News under<Link>procurement news.																		
8.	Last date & time for submission of Annexure I (i.e. Compliance to terms and condition of tender form) and EMD (Hard copy)	12-04-2024 by 03:00 PM Note: It is sole responsibility of the bidder to ensure submission of signed Annexure I along with EMD by stipulated date and time at specified address failing which they will not be eligible to participate in online price bidding.																		
9.	Address for submission of Annexure (i.e. Compliance to terms and condition form) and EMD (Hard Copy)	Regional Manager State Bank of India Regional Business Office I Ground Floor, BSNL-CTTC Building, Plot No.45-47, D-Road, MIDC, Satpur, Nashik-422 007.																		
10.	Date and time of opening of Online Technical bid and Price bid at SBI address mentioned at Sr. No.9	12-04-2024 at 03:30 PM																		
11.	Online price bids will be conducted by our approved e-tendering consultant	<table border="1"> <tr> <td>Primary Contact Numbers</td> <td>079-68136810,7990335262, 9081000427, 9904407997</td> </tr> <tr> <td>Pooja Shah</td> <td>9328931942 pooja.shah@eptl.in</td> </tr> <tr> <td>Khushboo Mehta</td> <td>9510813528 khushboo.mehta@eptl.in</td> </tr> <tr> <td>Nandan Valera</td> <td>+91-90810 00427 Nandan.v@eptl.in</td> </tr> <tr> <td>Dinesh Bagresha</td> <td>+91-9510812960 Dinesh.bagresha@eptl.in</td> </tr> <tr> <td>Devendra R</td> <td>+91-95108 12971 Devendra.r@eptl.in</td> </tr> <tr> <td>Nikhil Khalas</td> <td>+91 - 93745 19729 Nikhil@eptl.in</td> </tr> <tr> <td>Sujith Nair</td> <td>079-68136857, sujith@eptl.in</td> </tr> <tr> <td>Jaymeet Rathod</td> <td>07968136829, jaymeet.rathod@eptl.in</td> </tr> </table>	Primary Contact Numbers	079-68136810,7990335262, 9081000427, 9904407997	Pooja Shah	9328931942 pooja.shah@eptl.in	Khushboo Mehta	9510813528 khushboo.mehta@eptl.in	Nandan Valera	+91-90810 00427 Nandan.v@eptl.in	Dinesh Bagresha	+91-9510812960 Dinesh.bagresha@eptl.in	Devendra R	+91-95108 12971 Devendra.r@eptl.in	Nikhil Khalas	+91 - 93745 19729 Nikhil@eptl.in	Sujith Nair	079-68136857, sujith@eptl.in	Jaymeet Rathod	07968136829, jaymeet.rathod@eptl.in
Primary Contact Numbers	079-68136810,7990335262, 9081000427, 9904407997																			
Pooja Shah	9328931942 pooja.shah@eptl.in																			
Khushboo Mehta	9510813528 khushboo.mehta@eptl.in																			
Nandan Valera	+91-90810 00427 Nandan.v@eptl.in																			
Dinesh Bagresha	+91-9510812960 Dinesh.bagresha@eptl.in																			
Devendra R	+91-95108 12971 Devendra.r@eptl.in																			
Nikhil Khalas	+91 - 93745 19729 Nikhil@eptl.in																			
Sujith Nair	079-68136857, sujith@eptl.in																			
Jaymeet Rathod	07968136829, jaymeet.rathod@eptl.in																			

2 Signature & Seal of Contractor

		Nadeem Mansuri	079-68136853, nadeem@eptl.in
		Nandan Valera	079-68136843, nandan.v@eptl.in
		Hemangi Patel	079-68136852, hemangi@eptl.in
		Deepak Narekar	079-68136863, deepak@eptl.in
		Anshul Juneja	079-68136840, anshul.juneja@eptl.in
		Salina Motani	079-68136831, salina.motani@eptl.in
		Alternate Contact No	Mr. Udit:- 079-68136856, +918849722625,
12	For Technical query	Civil Engineer, Admin Office, Nashik, 7600056174	
13	Liquidated Damages	0.50% of contract amount per weeks subject to max. 5% of contract value or final bill value.	
14	Rates	<p>Rates quoted shall be inclusive of all existing & future (including variation) taxes, duties, levies, royalties, transportation, other incidental charges, WCT etc. PVA & PVA Clause shall not be applicable. Note: GST will be paid Extra as per Applicable norms.</p> <p>If any tenderer puts any condition/anything/any taxes extra over and above their quoted rates the tender shall be summarily rejected.</p>	
15	Defects liability period	12 Months from the date of Virtual Completion	
16	Validity of offer	90 days from the date of opening of Price-bid	
17	Value of Interim Certificate	<p>No interim payment shall be paid only full and final payment shall be paid [No advance on materials / plant / machinery or mobilization advance shall be paid under any circumstances]</p>	
18.	Insurance	The contractor shall obtain all necessary insurance policies as per the governing laws applicable at the center & shall be required to produce the original policy of Insurance & receipt of the premium as applicable in the matter to the Architect/Bank.	
19	Additional Security Deposit	<p>In case L-1 bidder quotes abnormally low rates (i.e. 7.50% or more, below estimated project cost), the Bank may ask such bidder to deposit additional security deposit (ASD) equivalent to difference between 92.5 % of estimated cost put to tender and the L-1 quoted amount for due fulfillment of contract. Such ASD could be in the form of FDR / Bank's guarantee in the Bank's name as per format approved by the Bank. On successful completion of work ASD will be returned to the contractor. In case contractor fails to complete the work in time or as per tender specification or leave the job incomplete, the bank will be at liberty to recover the dues from ASD or to forfeit such ASD within its sole discretion.</p>	

20	Tenders can be downloaded from the bank's website www.sbi.co.in (link) <SBI In the news <Procurement News>. It shall be responsibility of the contractor to timely submit the technical and financial bid. SBI, in no case shall be responsible for site issues/ delay in tender submission.
21	The contractor shall read and understand each page of the tender document thereby ensuring the number and sequence of all pages.
22	No conditions other than mentioned in the tender will be considered, and if given they will have to be withdrawn before submission of final quote, else their bid will be rejected. Claims for revision of the quoted price by any bidder after submission of tender will not be entertained. Any clarifications sought after opening of the tenders will not be entertained at any cost. Firm should visit the website regularly till last date for submission of tender regarding changes/ corrigendum, if any publish by Bank.
23	The SBI reserve their rights to accept or reject any or all the tenders, either in whole or in part without assigning any reason(s) for doing so and no claim / correspondence shall be entertained in this regard.
24	Tenders received without submission / uploading of Annexure I of technical bid, EMD shall be summarily rejected, and such tenders shall not be allowed to participate in the Price bid process / rejected. . If vendor submitted MSME certificate & Process compliance form online which will be considered.
25	In case the date of opening of tenders is declared as a holiday or due to administrative reasons if tenders not opened on mentioned date then tenders will be opened on the next working day at the same time and no separate communication to individual shall be made.
26	SBI has the right to accept / reject any / all tenders without assigning any reasons and no correspondence shall be entertained in this regard.
27	The Bank will place order as per its requirement and quoting minimum rate for any category does not provide any guarantee for receiving order for that item by the firm who quotes lowest rates.
28	Bank reserves right to cancel any / all tender sat any stage without assigning any reasons.
29	The Bank reserves the right to accept the tender in full or in part and the tenderer shall have no claim for revision of rates or other condition if his tender is accepted in parts.
30	L-1 Tenderer signed copy of entire tender document, price bid etc complete should be submit within 3 days from date of tender opening.
31	SBI reserves the right to accept or reject any or all the tenders without assigning any reason whatsoever. For any clarification regarding E-Tendering procedure, System requirements etc please contact M/s e-Procurement Technologies Limited, B-704, Wall Street - II, Opp. Orient Club, Nr. Gujarat College, Ahmedabad 380 006. Gujarat State, India.
32	It is vendor's/supplier's responsibility to be well prepared and get ready with E-Tendering procedures & well equipped with all requirements. SBI will not take any responsibility of delay in submission due to

Yours Faithfully,

(For and on behalf of SBI)
Regional Manager
State Bank of India
Regional Business Office I

4 Signature & Seal of Contractor

ANNEXURE I

(The bidders are required to print this on their company's letter head and sign, stamp before emailing and online submission)

COMPLIANCE TO TERMS AND CONDITION OF TENDER

Regional Manager
State Bank of India
Regional Business Office I
Ground Floor, BSNL-CTTC Building,
Plot No.45-47, D-Road, MIDC, Satpur, Nashik-422 007.

Subject: Undertaking to Compliance to terms and condition for Furniture works SBI **SME Nashik Branch**,
Dist: **Nashik**

We hereby confirmed that we have studied entire Technical bid terms and conditions, price bid, Drawing etc complete vide Tender reference no. **MAHNSK202403**. We also submitting our consent as we have accepted entire tender document without any deviation and we are ready to execute entire work as per Bank's standard terms and Condition mentioned in Technical bid, specifications mentioned in price bid and as per Drawings issued by Bank time to time. Further, if our firm is L1 in competitive bidding process, then immediately we will submit complete set of signed documents of Technical bid, price bid, drawings to the Bank. We further, execute entire work in quality norms.

Any presumptions, assumptions, deviation given or attached as part of document be treated as null and void.

Signature and Seal of firm

INSTRUCTIONS TO THE TENDERERS

Scope of work

INTERIOR FURNISHING WORK FOR SBI SME NASHIK BRANCH, DIST : NASHIK

Tender documents

The work has to be carried out strictly according to the conditions stipulated in the tender consisting of the following documents and the most workmen like manner.

- Instructions to tenderers
- General conditions of Contract
- Special conditions of Contract
- Price bid

The above documents shall be taken as complementary and mutually explanatory of one another but in case of ambiguities or discrepancies, shall take precedence in the order given below:

- a. Price Bid
- b. Technical specifications
- c. Special conditions of contract
- d. General conditions of contract
- e. Instructions to Tenderers

Complete set of tender documents including relative drawings can be downloaded from the Bank's website **BANK.SBI** under SBI in the News <Link>procurement news as per schedule furnished in the NIT.

The tender documents are not transferable.

Site Visit

The tenderer must obtain himself on his own responsibility and his own expenses all information and data that may be required for the purpose of filling this tender document and enter into a contract for the satisfactory performance of the work. The tenderer is requested satisfy himself regarding the availability of water, power, transport and communication facilities, the character quality and quantity of the

materials, labour, the law and order situation, climatic conditions local authorities requirement, traffic regulations etc.

The tenderer shall be solely responsible for considering the financial effect of any or all the factors while submitting his tender.

No interest will be paid on the EMD.

EMD of unsuccessful tenderer will be refunded within 30 days of award of Contract. EMD

of successful tenderer will be retained as a part of security deposit.

5.0 Initial/ Security Deposit

The successful tenderer will have to submit a sum equivalent to 2% of accepted tender value less EMD by means of DD drawn in favour of SBI. Payable at **Nashik** within a period of 10 days from the date of receipt of Letter of Intent (LOI)/ Work Order from SBI.

No interest shall be paid to the amount retained by the SBI as Security Deposit.

6.0 Signing of contract Documents

The successful tenderer shall be bound to implement the contract by signing an agreement and conditions of contract with the respective Circles (LHOs) of SBI within 15 days from the receipt of intimation of acceptance of the tender by the SBI. However, the written acceptance of the tenders by the Bank will constitute a binding agreement between the Bank and successful tenderer whether such formal agreement is subsequently entered into or not.

7.0 Completion Period

Time is essence of the contract. The work should be completed in all respect accordance with the terms of contract within a period of **45 days** from the date of award of work.

8.0 Validity of tender

Tenders shall remain valid and open for acceptance for a period of **90 days** from the date of opening price bid. If the tenderer withdraws his/her offer during the value period or makes modifications in his/her original offer which are not acceptable to Bank without prejudice to any other right or remedy the Bank shall be at liberty forfeit the EMD.

9.0 Liquidated Damages

The liquidated damages on account of delay shall be 0.50% of Cumulative Awarded value per week subject to a maximum of 5% of Cumulative awarded contract value or actual Invoice Value.

Rate and prices:

In case of item rate tender

The tenderers shall quote their rates for individual items both in words and figure. In case of discrepancy between the rate quoted in words and figures, the unit rate quantity in words will prevail. The amount of each item shall be calculated and the requisite total is given. In case of discrepancy between the unit rate and the total amount calculated from multiplication of unit rate and the quantity the unit rate quoted will govern and the amount will be corrected.

If no rate is quoted for one or more tender items, such tenders shall be treated as **Non-Responsive Tenders** and the same shall be summarily rejected.

The tenderers should not change the units as specified in the tender. If any unit is changed the tenders would be evaluated as per the original unit and the Contractor/ Vendor would be paid accordingly.

1.1.3 The tenderer should not change or modify or delete the description of the item. If any discrepancy is observed he should immediately bring to the knowledge of the **SBI**.

Each page of the BOQ shall be signed by the authorized person and cutting or overwriting shall be duly attested by him.

Each page shall be totaled and the grand total shall be given.

The rate quoted shall be firm and shall include all costs, allowances, taxes, levies etc complete during the currency of contract including authorized extension, if any, but excluding GST, which shall be mentioned in the bills/invoices separately, as applicable.

The SBI reserve their rights to accept any tenders, either in whole or in part or may entrust the work in phases or may drop the part scope of work at any stage of the project within its sole discretion without assigning any reason(s) for doing so and no claim / correspondence shall be entertained in this regard.

In case, it is decided by the SBI to drop one or more Items from the scope of work at any stage of the project, the Contractor/ Vendor shall not be entitled to raise any claim /compensation for such deleted scope of work. Also, the SBI may consider issuing work order for various branches/offices in phases but within a reasonable time interval and the Contractor/ Vendor shall be bound to execute the same within the stipulated time period and as per rates quoted by them in this tender without any claim for price escalation.

LETTER OF UNDERTAKING

Regional Manager
State Bank of India
Regional Business Office I
Ground Floor, BSNL-CTTC Building,
Plot No.45-47, D-Road, MIDC, Satpur, Nashik-422 007.

Dear Sir,

Having examined the drawings, specification, design and schedule of quantities relating to the works specified in the memorandum hereinafter set out and having visited and examined the site of the works specified in the said memorandum and having acquired the requisite information relating thereto as affecting the tender, I/We hereby offer to execute the works specified in the said memorandum at the rates mentioned in the attached Schedule of Quantities and in accordance in all respects with the specifications, design, drawings and instructions in writing referred to in conditions of tender, the Articles of Agreement, Special Conditions, Schedule of Quantities and Conditions of Contract and with such materials as are provided for by, and in all other respects in accordance with such conditions so far as they may be applicable.

MEMORANDUM

(a)	Description of work	Proposed Interior Furnishing works of <u>SBI SME Nashik Branch, Dist: Nashik</u>
(b)	Earnest Money	22,700.00/- (Rupees Twenty Two Thousand Seven Hundred Only) by means of Demand Draft / Pay Order (Valid for a period of 90 Days from the last date of submission of the tender) from any scheduled Nationalized Bank drawn in favour of State Bank Of India payable at Nashik. EMD in the form of Cheque will not be accepted. Tender will be rejected if EMD not submitted in hard copy.
(c)	Time allowed for completion of the Works from Seven day after the date of written Order or date of handing over of the site (Whichever is later) to commence the work	45 days

- 1) Should this tender be accepted, I/we hereby agree to abide by and fulfill the terms and provisions of the said conditions of contract annexed hereto so far as may be applicable

or in default thereof to forfeit and pay to SBI, the amount mentioned in the said contract.

- 2) I / We have deposited a sum of **Rs. 22,700.00/- (Rupees Twenty Two Thousand Seven Hundred Only)** of the total tender amount as Earnest Money with the SBI which amount is not to bear any interest. Should I / We fail to execute the Contract when called upon to do so I / We do hereby agree that this sum shall be forfeited by me/us to State Bank of India.
- 3) I/ We understand that as per terms of this tender, the SBI may consider accepting our tender in part or whole or may entrust the various work proposed in phases. We, therefore, undertake that we shall not raise any claim/ compensation in the eventuality of Bank deciding to drop any of the work from the scope of work of this tender at any stage during the contract period. Further, we also undertake to execute the work entrusted to us in phases on our approved rates and within stipulated time limit without any extra claim for price escalation as also provided for in the clause 11.1.6 "Instructions to Tenderers" of this tender.
- 4) I/ We, hereby, also undertake that, we will not raise any claim for any escalation in the prices of any of the material during the contract/execution/completion period including authorized extended contract period, if any.

5) Our Bankers are:

i)

ii)

The names of partners of our firm are:

i)

ii)

Name of the partner of the firm

Authorised to sign

Or

(Name of person having Power of Attorney to sign the Contract.

(Certified true copy of the Power of Attorney should be attached)

Yours faithfully,

Signature of Contractors.

Signature and addresses of Witnesses

i)

ii)

**ONLINE E-TENDERING FOR PROPOSED INTERIOR FURNISHING WORKS OF SBI
SME Nashik BRANCH, DIST: NASHIK**

SAMPLE BUISNESS RULE DOCUMENT

Business rules for E-tendering:

1. Only MAHARASHTRA CIRCLE **empaneled FURNITURE contractors** under appropriate category who are invited by the project Architect/SBI shall only be eligible to participate.
2. SBI will engage the services of an E-tendering service provider who will provide necessary training and assistance before commencement of online bidding on Internet.
3. In case of e-tendering, SBI will inform the vendor in writing, the details of service provider to enable them to contact and get trained.
4. Business rules like event date, closing and opening time etc. also will be communicated through service provider for compliance.
5. Contractors have to send by email, the compliance form in the prescribed format (provided by service provider), before start of E-tendering. Without this the vendor will not be eligible to participate in the event.
6. The Contractors will be required to submit the various documents in sealed Envelope to the office of SBI at the address mentioned hereinbefore by the stipulated date i.e. (1) Hard Copy of Technical Bid duly signed and stamped on each page (2) Demand Draft of specified amount of EMD. Contractors not submitting any one or more documents shall not be eligible to participate in the on-line price bidding.
7. E-tendering will be conducted on schedule date &time.
8. **The e-tendering will be treated as closed only when the bidding process gets closed in all respects for the item listed in the tender.**

(B) Terms & conditions of E-tendering:

SBI shall finalize the Tender through e-tendering mode for which **M/s. e-Procurement Technology, Ahmedabad** has been engaged by SBI an authorized service provider. Please go through the guidelines given below and submit your acceptance to the same along with your Commercial Bid.

1. E-tendering shall be conducted by SBI through **M/s. e-Procurement Technology, Ahmedabad.**, on pre-specified date. While the Contractors shall be quoting from their own offices/ place of their choice, Internet connectivity and other paraphernalia requirements shall have to be ensured by Contractors themselves. In the event of failure of their Internet connectivity, (due to any reason whatsoever it may be) it is the bidders' responsibility

In order to ward-off such contingent situation bidders are requested to make all the necessary arrangements/alternatives such as back-up power supply whatever required so that they are able to circumvent such situation and still be able to participate in the E-tendering successfully. Failure of power at the premises of Contractors during the E-tendering can not be the cause for not participating in the E-tendering. On account of this the time for the E-tendering can not be

extended and SBI is not responsible for such eventualities.

2. **M/s.e-Procurement Technology, Ahmedabad.**, shall arrange to train you nominated person(s), without any cost to you. They shall also explain you all the Rules related to the E-tendering. You are required to give your compliance on it before start of bid process.
3. **BIDDING CURRENCY AND UNIT OF MEASUREMENT:** Bidding will be conducted in Indian currency & Unit of Measurement will be displayed in Online E-tendering.
4. **BID PRICE:** The Bidder has to quote the rate as per the Tender Document provided by SBI their appointed Architects.
5. **VALIDITY OF BIDS:** The Bid price shall be firm for a period specified in the tender document and shall not be subjected to any change whatsoever.
6. **Procedure of E-tendering:**

i. Online E-tendering:

- (a) The hard copy of the Technical as well as Price Bid is available on the Bank's website during the period specified in the NIT.
 - (b) Online e-tendering is open to the empanelled bidders who receive NIT from the Architect and qualified for participating in the price bidding as provisions mentioned hereinabove through SBI approved Service Provider.
 - (c) The Price-Bid shall be made available online by the Service Provider wherein the contractors will be required to fill-in percentage Above/Below over given Estimated amount.
 - (d) The Contractors are advised not to wait till the last minute to submit their online item-wise quote in the price bid to avoid complications related with internet connectivity, network problems, system crash down, power failure, etc.
 - (e) It is mandatory to all the bidders participating in the price bid to quote their rates for each and every item.
 - (f) In case, contractor fails to quote their rates for any one or more tender items, their tender shall be treated as "**Incomplete Tender**" and shall be liable for rejection.
7. **LOG IN NAME & PASSWORD:** Each Bidder is assigned a Unique User Name & Password by M/s. **e-Procurement Technology, Ahmedabad**. The Bidders are requested to change the Password after the receipt of initial Password from M/s. **e-Procurement Technology, Ahmedabad**. All bids made from the Login ID given to the bidder will be deemed to have been made by the bidder.
 8. **BIDS PLACED BY BIDDER:** Bids will be taken as an offer to execute the work as specified. Bids once made, cannot be cancelled / withdrawn and the Bidder shall be bound to execute the work at the quoted bid price. In case the L1 Bidder backs out or fail to complete the work **as per the rates quoted**, SBI shall have the liberty to take action as deemed necessary including de-paneling such contractors and forfeiting their EMD and imposing heavy penalty to contractor to recover the losses occurred to the Bank.

9. At the end of the E-tendering, SBI will decide upon the successful bidder. SBI decision on award of Contract shall be final and binding on all the Bidders.
10. SBI shall be at liberty to cancel the E-tendering process/tender at anytime, before ordering, without assigning any reason.
11. SBI shall not have any liability to bidders for any interruption or delay in access to the site irrespective of the cause.
12. Other terms and conditions shall be as per your techno-commercial offers and other correspondences till date.
13. OTHER TERMS & CONDITIONS:
 - The Bidder shall not involve himself or any of his representatives in Price manipulation of any kind directly or indirectly by communicating with other suppliers/ bidders.
 - The Bidder shall not divulge either his Bids or any other exclusive details of SBI to any other party.
 - SBI decision on award of Contract shall be final and binding on all the Bidders.
 - SBI reserve their rights to extend, reschedule or cancel any E-tendering within its sole discretion.
 - SBI or its authorized service provider M/s. **e-Procurement Technology, Ahmedabad** shall not have any liability to Bidders for any interruption or delay in access to the site irrespective of the cause.
 - SBI or its authorized service provider M/s. **e-Procurement Technology, Ahmedabad** is not responsible for any damages, including damages that result from, but are not limited to negligence.
 - SBI or its authorized service M/s. **e-Procurement Technology, Ahmedabad** will not be held responsible for consequential damages, including but not limited to systems problems, inability to use the system, loss of electronic information etc.

N.B.

- All the Bidders are required to submit the Process Compliance Statement (Annexure-II) duly signed to M/s. **e-Procurement Technology, Ahmedabad**.
- All the bidders are requested to ensure that they have a valid digital signature certificate well in advance to participate in the online event.

Process Compliance Statement (Annexure III)

To,
M/s. **e-Procurement Technology**,
B-705, Wall Street - II, Opp. Orient Club, Ellisbridge,
Ahmedabad – 380006,
State Gujarat, India
E-mail : jayprakash@auctiontiger.net
Contact No.- 079-68136810, 079-68136815, 07990335262, 8849722625,

AGREEMENT TO THE PROCESS RELATED TERMS AND CONDITIONS FOR THE ONLINE E-TENDERING FOR PROPOSED INTERIOR FURNISHING WORK OF SBI SME NASHIK BRANCH

Dear Sir,

This has reference to the Terms & Conditions for the E-tendering mentioned in the Tender document This letter is to confirm that:

- 1) The undersigned is authorized representative of the company.
- 2) We have studied the Commercial Terms and the Business rules governing the E-tendering as mentioned in RFP of SBI as well as this document and confirm our agreement to them.
- 3) We also confirm that we have taken the training on the E-tendering tool and have understood the functionality of the same thoroughly.
- 4) We confirm that SBI and M/s. **e-Procurement Technology, Ahmedabad** shall not be liable & responsible in any manner whatsoever for my/our failure to access & bid on the e-E-tendering platform due to loss of internet connectivity, electricity failure, virus attack, problems with the PC, any other unforeseen circumstances etc. before or during the E- tendering event.
- 5) We confirm that we have a valid digital signature certificate issued by a valid Certifying Authority.
- 6) We, here by confirm that we will honor the Bids placed by us during the E-tendering process.

With regards, Date:

Signature with company seal Name:

Company / Organization:

Designation within Company / Organization: Address of Company / Organization:

Scan it and send to this Document on -----

SECTION – 1

INSTRUCTIONS TO THE TENDERERS

1.0 Scope of work

Sealed Tender followed by price bidding (on Item rate basis) are invited by SBI for Proposed Interior Furnishing works of **SBI SME Nashik Branch, Nashik**

2.0 Tender Documents

2.1 The work has to be carried out strictly according to the conditions stipulated in the tender consisting of the following documents and the most workmen like manner.

Instructions to tenderers

General conditions of

Contract Special conditions

of Contract Additional

Specifications Drawings

Priced bid A

2.2 The above documents shall be taken as complementary and mutually explanatory of one another but in case of ambiguities or discrepancies, shall take precedence in the order given below;

- a) Price Bid
- b) Additional Specifications
- c) Technical specifications
- d) Drawings
- e) Special conditions of contract
- f) General conditions of contract
- g) Instructions to Tenderers

2.3 Complete set of tender documents including relative drawings can be downloaded from the website www.sbi.co.in

2.4 The tender documents are not transferable.

3.0 Site Visit:

3.1 The tenderer must obtain himself on his own responsibility and his own expenses all information and data that may be required for the purpose of filling this tender document and enter into a contract for the satisfactory performance of the work. The tenderer is requested satisfy himself regarding the availability of water, power, transport and communication facilities, the character quality and quantity of the materials, labour, the law and order situation, climatic conditions local authorities requirement, traffic regulations etc; The tenderer will be

fully responsible for considering the financial effect of any or all the factors while submitting his tender.

4.0 Earnest Money:

4.1 The tenderers are requested to submit the Earnest Money **Rs. 22,700.00/- (Rupees Twenty Two Thousand Seven Hundred Only)** by means of Demand Draft / Pay Order (Valid for a period of 90 Days from the last date of submission of the tender) from any scheduled Nationalized Bank drawn in favour of State Bank of India at payable **Nashik**.

4.2 EMD in any other form other than as specified above will not be accepted. Tender not accompanied by the EMD in accordance with clause 4.1 above shall be rejected

4.3 No interest will be paid on the EMD.

5.0 Initial Security Deposit:

5.1 Security Deposit:

For the successful bidder, total security deposit shall be 5% of the contract value. Out of this, 2% of the contract value will be in the form of Initial Security Deposit (ISD); which includes the EMD. Balance 3 % retention amount shall be deducted from the running account bill of the work at the rate of the 10% of respective running account bill i.e. deduction from each running bill account will be 10%, till the 5% of the contract value is achieved. In case running bills are not applicable, whole 3% of the remaining SD will be deducted from the final bill paid. The 50% of the Total Security Deposit shall be paid to the contract on the basis of architect's certifying the virtual completion. The balance 50% would be paid to the contractors after completion Defects Liability Period as specified in the contract/ work order.

5.2 Signing of contract Documents:

The contractor who accept the standard rates shall be bound to implement the contract by signing an agreement and conditions of contract attached herewith within 15 days from the receipt of intimation of acceptance of the tender by the Bank. However, the written acceptance of the bidder by the Bank will constitute a binding agreement between the Bank and contractor who accept the L-1 rates (Standard Rates) whether such formal agreement is subsequently entered in to or not.

6.0 Completion Period:

Time is essence of the contract. The work should be completed in all respect accordance with the terms of contract within the stipulated period from the date of award of work.

7.0 Validity of Tender: As per NIT

If the tenderer withdraws his/her offer during the value period or makes modifications in his/her original offer which are not acceptable to Bank without prejudice to any other right or remedy the Bank shall be at liberty to forfeit the EMD.

8.0 Liquidated Damages:

The liquidated damages shall be 0.50% per week subject to a maximum of 5% of contract value.

9.0 Rate and Prices:

9.0.1 In case of item rate tender:

The tenderers shall quote their rates for individual items both in words and figure. In case of discrepancy between the rate quoted in words and figures, the unit rate quantity in words will prevail. If no rate is quoted for a particular item, the contractor shall not be paid for that item when it is executed. The amount of each item shall be calculated, and the requisite total is given. In case of discrepancy between the unit rate and the total amount calculated from multiplication of unit rate and the quantity the unit rate quoted will govern and the amount will be corrected.

The tenderers need not quote their rates for which no quantities have been given. In case the tenderers quote their rates for such items those rates will be ignored and will not be considered during execution. The tenderers should not change the units as specified in the tender. If any unit is changed the tenders would be evaluated as per the original unit and the contractor would be paid accordingly. The tenderer should not change or modify or delete the description of the item. If any discrepancy is observed he should immediately bring to the knowledge of the Architect/ SBI each page of the BOQ shall be signed by the authorized person and cutting or over writing shall be duly attested by him. Each page shall be totaled and the grand total shall be given. The rate quoted shall be firm and shall include all costs, allowances, materials, labors, taxes etc. except G.S.T, which shall be payable / reimbursed at actual. The SBI reserve their rights to accept any tenders, either in whole or in part or may entrust the work in phases or may drop the part scope of work at any stage of the project within its sole discretion without assigning any reason(s) for doing so and no claim / correspondence shall be entertained in this regard.

10.0 Material having basic price: If the basic rate of any material actually used for the work is more or less than the basic rate given in schedule of quantities, in the case the difference will be calculated (either plus or minus) and shall be paid or recovered from the contractor. GST shall be excluded from the basic rate and will include all other taxes, transportation, loading, unloading, etc complete in all respect. Rates should be however, fair and competitive and verified by market enquiry by the bank and the quantity purchased in every period should be reasonable and advantageous, if any due to bulk purchase may be also taken into account. The SBI Reserve their rights to accept any tenders, either in whole or in part or may entrust the work in phases or may drop the part scope of work at any stage of the project within its sole discretion without assigning any reason(s) for doing so and no claim/correspondence shall be entertained in this regard.

Signature of The Contractor With Seal

GENERAL & IMPORTANT NOTES

1 GENERAL NOTES:

- (i) Unless otherwise specified in these tender documents mode of measurements specifications etc. shall be as per relevant IS codes.
- (ii) Source of materials / samples / brands / makes etc. shall be got approved from the Architects / Bank before using. In case of deviations, decision of the Bank shall be final and binding and shall not be open for arbitration.
- (iii) The Architects have their specific role / duties / rights as defined in these tender documents. However in the event of any dispute arising out of differences between the opinions of the Architects and also their role/ duties/rights, the Banks' decision shall be final & binding on the Architects and the Contractor and shall not be open to arbitration.
- (vi) The Contractor will extend full co-operation, support and all required assistance to Architect / Bank for discharging their duties and responsibilities efficiently and effectively.
- (vii) **The contractor has to supply and adhere to the specific makes and specifications of all the items, which are mentioned in the separate list of approved makes. Any work found not as per the tender specifications and list of approved the contractor has to replace the same without any delay. The contractor is instructed of get approval of all the materials to be used on this site before starting the work. He should provide different sample of material for approval, before execution of work.**
- (viii) All quantities indicated in the tender are approximate & are likely to change. The contractor must take actual measurement at site and billing shall be done as per the actual measurement of the work done at site.
- (ix) Work has to be got executed at site in coordination with various agencies working at site.
- (x) The contractor is instructed to get the approval of the materials to be used on this site before starting the work. He shall provide different sample of materials for approval before execution of the work
- (xi) All material have to be used in full size/length only. Joints should be avoided as far as possible.
- (xii) Any item mentioned in the BOQ with "TO THE SHAPE" will have measurement of onsite executed to the shape area only.
- (xiii) Making various levels & line out for total layout on site for the items in scope of the work shall be done by the contractor at his own cost.
- (xiv) MTC (Manufacturer Test certificate) Where ever applicable shall be arranged & submitted by the contractor. Testing of wood for moisture, knot % etc. shall be carried out by the contractor at his own cost.
- (xv)

2. IMPORTANT NOTES:

- (i) The contractor's qualified & authorized representative shall remain on site during the entire execution process for coordination with various agencies / Architect / Bank & execution of work.
- (ii) If the assigned work is in running/working Branch, the contractor should have execute the site erection work in odd hours, Holidays and Sundays.
- (iii) The contractor shall prepare all loose furniture items at his workshop only & deliver the same to the site at appropriate time as instructed by the Architect/BMs/Bank Officials.
- (iv) The site shall be cleaned on day-to-day basis & all debris shall be disposed away at the location beyond the limit as approved by the local authority.
- (v) Hidden measurements:- It is contractor's responsibility to get the measurement checked immediately on completion of such items. This shall be done before finishing the same. The Architect shall be provided with such details well in advance so that the other work is not held up due to last moment action.
- (vi) Before starting the work at site, the contractor shall mark out the plan & levels of the false ceiling, partitions etc. in coordination with other agencies on site.
- (vii) The rates quoted shall be inclusive of all taxes, Duties, Octroi, Transportation, Delivery, Installation, Testing, Commissioning etc. complete at the site. No extra will be paid for any kind of taxes. However the GST will be paid extra as applicable as per actual.
- (viii) The entire job shall be executed in total coordination with the other agencies working on the project & also with landlord, Branch Manager and Bank officials etc.
- (ix) Architect of the project shall be kept informed about the progress of the work at various stages.
- (x) The contractor shall arrange on his own for lighting & plug point with socket & electrical wiring, DB's etc. required during entire execution process. However supply at point shall be provided by the bank / landlord
- (xi) Any Hidden item MUST be photographed and need to be sent via e- mail or CD to Architect / Bank
- (xii) BILLING PROCESS:

The contractor/Architect should take care of the following while submitting the final Bill

The Final Bill Should Contain:-

- a) Abstract in tender BOQ format only.
- b) Schedules for detailed measurement sheet for all items (in detailed break up).
- c) Original insurance policies as per tender terms and conditions.
- d) Completion certificate issued by the concerned Architect.
- e) Inspection & completion certificates for all types of false ceiling.

- f) Test report for Toughened Glass.
- g) Copy of LOA etc.
- h) All documents shall carry contractor's signature & seal with address. - All documents shall be submitted in 1 + 1 copies.
- i) The contractor shall also provide all measurement sheet in soft copy (in Excel format).
- j) The contractor shall submit the purchase bill copy of major items used in the project.
- k) That extension of time, if any, beyond scheduled date of completion has been granted by the Competent Authority.
- l) Original receipt of purchase of Corian/plywood/Gypboard and other major materials used in the work from the original manufacturer/authorized dealers/distributors.
- m) If any advances paid during the execution of the work.
- n) Acceptances form the contractor that "Accepted as full and final settlement of all claims"
- o) The total cost of work should be within the sanction amount, If not, revised sanction taken from the Competent Authority to be attached with the Final Bill

IMPORTANT: ALL DOCUMENTS SHALL BE SUBMITTED AT ONCE (NOT IN PIECEMEAL MANNER) ALONG WITH FULL&FINAL BILL &SHALL BE DULY SIGNED BY PUTTING COMPANY'S ADDRESS SEAL

GENERAL CONDITIONS OF CONTRACT

1.0 Definitions:

=

“Contract means the documents forming the tender and the acceptance thereof and the formal agreement executed between SBI (client) and the contractor, together with the documents referred there in including these conditions, the specifications, designs, drawings and instructions issued from time to time by the Architects / Bank and all these documents taken together shall be deemed to form one contract and shall be complementary to one another.

In the contract the following expressions shall, unless the context otherwise requires, have the meaning hereby respectively assigned to them.

1.0.1 ‘SBI shall mean SBI having its **Regional Manager, State Bank of India, Regional Business Office - I, BSNL-CTTC Building, Nashik – 422 007.**

and includes the client’s representatives, successors and assigns.

1.0.2 ‘Architects / Consultants’ shall mean ~~-----~~ Architects & Interior Designers, ~~-----~~

1.0.3 ‘Site Engineer’ shall mean an Engineer appointed by the SBI at site as their representative for day-to- day supervision of work and to give instructions to the contractors.

1.0.4 ‘The Contractor’ shall mean the individual or firm or company whether incorporation, undertaking the works and shall include legal personal representative of individual or the composing the firm or company and the permitted assignees of individual or firms of company.

The expression ‘works’ or ‘work’ shall mean the permanent or temporary work description in the “Scope of work” and/or to be executed in accordance with the contract includes materials, apparatus, equipment, temporary supports, fittings and things of kinds to be provided, the obligations of the contractor hereunder and work to be done by the contractor under the contract.

1.0.5 ‘Engineer’ shall mean the representative of the Architect/Consultant.

1.0.6 ‘Drawings’ shall mean the drawings prepared by the Architects and issued by the Engineer and refer red to in the specifications and any modifications of such drawings as may be issued by the Engineer from time to time Contract value shall mean value of the entire work as stipulated in the letter of acceptance of tender subject such additions there to or deductions there from as may be made under the provide herein after contained.

1.0.7 Specifications’ shall mean the specifications referred to in the tender and modifications thereof as may time to time be furnished or approved by the Architect/Consultant.

1.0.8 “Month” means calendar month.

1.0.9 “Week” means seven consecutive days.

1.0.10 “Day” means a calendar day beginning and ending at 00 Hrs and 24 Hrs respectively.

1.1.11 “SBI Engineer” shall mean The Civil/Electrical Engineer in-charge of the Project, as nominated by the AGM (P&E-Maharashtra Circle) SBI, Mumbai// **Competent Authority, Nashik.**

1.1.12 The following shall constitute the Joint Project Committee (herein under referred to as JPC) for assessing and reviewing the progress of the work on the project and to issue instructions or directions from time to time for being observed and followed by the Architects Site Engineer / PMC and other consultants / contractors engaged in the execution of the project.

- i) Assist General Manager – (P &E)
- ii) SBI Engineer (Furniture and Electrical) in-charge of the Project.
- iii) Concerned partner of the Architects and their Resident Architect Member.

2.0 Language

The language in which the contract documents shall be drawn shall be in English.

3.0 Errors, Omissions and discrepancies

In case of errors, omissions and/ or disagreement between written and scaled dimensions on the drawings or between the drawings and specifications etc., the following order shall apply.

- i) Between scaled and written dimension (or description) on a drawing, the latter shall be adopted.
- ii) Between the written or shown description or dimensions in the drawings and the corresponding one in the specification the former shall be taken as correct.
- iii) Between written description of the item in the specifications and descriptions in bills of quantities of the same item, the former shall be adopted:
 - a) In case of difference between rates written in figures and words, the rate in words shall prevail.
 - b) Between the duplicate / subsequent copies of the tender, the original tender shall be taken as correct.

4.0 Scope of Work:

The Contractor/ Vendor shall carryout, complete and maintain the said work in every respect strictly accordance with this contract and with the directions of and to the satisfaction of the Bank to be communicated through SBI. The SBI at the direction of the Bank from time to time issue further drawings and / or written instructions, detailed directions and explanations which are hereafter collectively referred to as instructions in regard to the variation or modification of the design, quality or quantity of any work or the addition or omission or substitution work. Any discrepancy in the drawings or between BOQ and / or drawings and / or specifications should be brought to the notice of SBI immediately. The removal from the site of any material brought thereon by the Contractor/ Vendor and any substitution of any other materials therefore the removal and / or re-executed of any work executed by him. The dismissal from the work of any person engaged thereupon.

5.0 i) Letter of Acceptance:

Within the validity period of the tender the SBI shall issue a letter of acceptance directly by registered post or otherwise depositing at the office of the Contractor/ Vendor as given in the tender to enter into a Contract for the execution of the work as per the terms of the tender. The letter of acceptance shall constitute a binding contract between the SBI and the Contractor/ Vendor.

ii) **Contract Agreement:**

On receipt of intimation of the acceptance of tender from the SBI the successful tenderer shall be bound to implement the contract and within ten days there of shall sign an agreement in a non-judicial stamp paper of appropriate value.

6.0 **Ownership of drawings:**

All drawings, specifications and copies thereof furnished by the SBI are the properties of the SBI. They are not to be used on other work.

7.0 **Detailed drawings and instructions:**

The SBI shall furnish with reasonable proper additional instructions by means of drawings or otherwise necessary for the execution of the work. All such drawings and instructions shall be consistent with contract documents, true developments thereof and reasonably inferable there.

The work shall be executed in conformity therewith and the Contractor/ Vendor prepare a detailed program schedule indicating therein the date of start and completion of various activities on receipt of the work order and submit the same to the SBI through the architect/consultant

7.0 **Copies of agreement**

Two copies of agreement duly signed by both the parties with the drawings shall be handed over to the Contractor/ Vendors.

8.0 **Liquidated damages:**

If the Contractor/ Vendor fails to maintain the required progress in terms of relevant clause under General Conditions of Contract (GCC) or to complete the work and clear the site including vacating their office on or before the contracted or extended date or completion, without justification in support of the cause of delay, he may be called upon without prejudice to any other right of remedy available under the law to the SBI on account of such breach to pay a liquidated damage at the rate of 0.50% of the contract value subject to a maximum of 5% of the contract value.

9.0 **Materials, Appliances and Employees:**

Unless or otherwise specified the Contractor/ Vendor shall provide and pay for all materials, labour, water, power, tools, equipment transportation and any other facilities that are required for the satisfactory execution and completion of the work. Unless or otherwise specified all materials shall be new and both workmanship and materials shall be best quality. The Contractor/ Vendor shall at all times enforce strict discipline and good order among his employees and shall not employ on the work any unfit person or anyone not skilled in the work assigned to him. Workman whose work or behavior is

found to be unsatisfactory by the SBI he shall be removed from the site immediately.

10.0 Permits, Laws and Regulations:

Permits and licenses required for the execution of the work shall be obtained by the Contractor/ Vendor at his own expenses. The Contractor/ Vendor shall give notices and comply with the regulations, laws, and ordinances rules, applicable to the contract. If the Contractor/ Vendor observes any discrepancy between the drawings and specifications, he shall promptly notify the SBI in writing. If the Contractor/ Vendor performs any act, which is against the law, rules and regulations he shall meet all the costs arising there from and shall indemnify the SBI any legal actions arising there from.

11.0 Setting out Work:

The Contractor/ Vendor shall set out the work and shall be responsible for the true and perfect setting out of the same and for the correctness of the positions, levels, dimensions, and alignment of all parts thereof and get it approved by the SBI before proceeding with the work. If at any time any error in this respect shall appear during the progress of the works, irrespective of the fact that the layout had been approved by SBI, the Contractor/ Vendor shall be responsible for the same and shall his own expenses rectify such error, if so, required to satisfaction of the SBI.

12.0 Protection of works and property:

The Contractor/ Vendor shall continuously maintain adequate protection of all his work from damage and shall protect the SBI's properties from injury or loss arising in connection with contract. He shall make good any such damage, injury, loss, except due to causes beyond his control and due to his fault or negligence.

He shall take adequate care and steps for protection of the adjacent properties. The Contractor/ Vendor shall take all precautions for safety and protections of his employees on the works and shall comply with all applicable provisions of Govt. and local bodies' safety laws and building codes to prevent accidents, or injuries to persons or property on about or adjacent to his place of work. The Contractor/ Vendor shall take insurance covers as per clause 24.0 at his own cost. The policy may be taken in joint names of the Contractor/ Vendor and the SBI and the original policy may be lodged with the SBI.

13.0 Inspection of work:

The SBI or their representatives shall at all reasonable times have free access to the work site and / or to the workshop, factories, or other places where materials are lying or from where they are obtained and the Contractor/ Vendor shall give every facility to the SBI and their representatives necessary for inspection and examination and test of the materials and workmanship. No person unless authorized by the SBI except the representative of Public authorities shall be allowed on the work at any time. The

proposed work either during its construction stage or its completion can also be inspected by the Chief Technical Examiner's Organization a wing of Central Vigilance commission.

14.0 Assignment and subletting

The whole of work included in the contract shall be executed the Contractor/ Vendor and he shall not directly entrust and engage or indirectly transfer, assign or underlet the contract or any part or share thereof or interest therein without the written consent of the SBI and no undertaking shall relieve the Contractor/ Vendor from the responsibility of the Contractor/ Vendor from active & superintendence of the work during its progress.

15.0 Quality of materials, workmanship & Test

All materials and workmanship shall be best of the respective kinds as described in the contract/BOQ and in accordance with SBI's instructions and shall be subject from time to time to such tests as the SBI. may direct at the place of manufacture or fabrication or on the site or an approved testing laboratory. The Contractor/ Vendor shall provide such assistance, instruments, machinery, labor, and materials as are normally required for examining measuring sampling and testing any material or part of work before incorporation in the work for testing as may be selected and required by the SBI.

ii) Samples

All samples of adequate numbers, size, shades & pattern as per specifications shall be supplied by the Contractor/ Vendor without any extra charges. If certain items proposed to be used are of such nature that samples cannot be presented or prepared at the site detailed literature / test certificate of the same shall be provided to the satisfaction of the SBI. Before submitting the sample / literature the Contractor/ Vendor shall satisfy himself that the material / equipment for which he is submitting the sample / literature meet with the requirement of tender specifications. Only when the samples are approved in writing by SBI the Contractor/ Vendor shall proceed with the procurement and installation of the particular material / equipment. The approved samples shall be signed by SBI for identification and shall be kept on record at site office until the completion of the work for inspection / comparison at any time. SBI shall take reasonable time to approve the sample. Any delay that might occur in approving the samples for reasons of its not meeting the specifications or other discrepancies inadequacy in furnishing samples of best qualities from various manufacturers and such other aspects causing delay on the approval of the materials / equipment etc. shall be to the account of the Contractor/ Vendor.

iii) Cost of tests

The cost of making any test shall be borne by the Contractor/ Vendor if such test is intended by or provided for in the specification or BOQ.

16.0 Obtaining information related to execution of work

No claim by the Contractor/ Vendor for additional payment shall be entertained which

is consequent upon failure on his part to obtain correct information as to any matter affecting the execution of the work nor any misunderstanding or the obtaining incorrect information or the failure to obtain correct information relieve him from any risks or from the entire responsibility for the fulfillment of contract.

17.0 Contractor/ Vendor's superintendence

The Contractor/ Vendor shall give necessary personal superintendence during the execution the works and as long, thereafter, as the SBI may consider necessary until the expiry of the defects liability period, stated here to.

18.0 Quantities

The bill of quantities (BOQ) unless or otherwise stated shall be deemed to have been prepared in accordance with the Indian Standard Method of Measurements and quantities. The rate quoted shall remain valid for variation of quantity against individual item to any extent.

19.0 Works to be measured

SBI may from time to time intimate to the Contractor/ Vendor that the work is required to be measured and the Contractor/ Vendor shall forthwith attend or send a qualified representative to assist the SBI in taking such measurements and calculation and to furnish all particulars or to give all assistance required by any of them. Such measurements shall be taken in accordance with the Mode of measurements detail in the specifications. The representative of SBI shall take measurements with the Contractor/ Vendor's representative and the measurements shall be entered in the measurement book. The Contractor/ Vendor or his authorized representative shall sign all the pages of the measurement book in which the measurements have been recorded in token of his acceptance. All the corrections shall be duly attested by both representatives. No over writings shall be made in the Measurement book should the Contractor/ Vendor not attend or neglect or omit to depute his representative to take measurements the measurements recorded by the representative of the SBI shall be final. All authorized extra work, omissions and all variations made shall be included such measurement.

20.0 Variations

No alteration, omission or variation ordered in writing by SBI vitiates the contract. In case the SBI thinks proper at any stage during the progress of works to make any alteration in, or additions to or omission from the works or any. alteration in the kind or quality of the materials to be used therein, the SBI shall give notice thereof in writing to the Contractor/ Vendor shall confirm in writing within seven days of giving such oral instructions the contract shall alter to, add to, or omit from as the case may be in accordance with such notice but the Contractor/ Vendor shall not do any work extra to or make any alterations or additions to or omissions from the works or any deviation from any of the provisions of the contract, stipulations, specifications or contract drawings without previous consent in writing of the SBI and the value of such extras, alterations, additions or omissions shall in all cases be determined by the SBI and the same shall be added to or deducted from the contract value,

as the case may be.

21.0 Valuation of Variations

No claim for an extra Item shall be allowed unless it shall have been executed under the authority of the SBI with the concurrence of the SBI as herein mentioned. Any such extra is herein referred to as authorized extra and shall be made in accordance with the following provisions.

- a) (i) The net rates or prices in the contract shall determine the valuation of the extra work where such extra work is of similar character and executed under similar conditions as the work priced herein.

(ii) Rates for all items, wherever possible should be derived out of the rates given in the priced BOQ.
- b) The net prices of the original tender shall determine the value of the items omitted, provided if omissions do not vary the conditions under which any remaining items of Works are carried out, otherwise the prices for the same shall be valued under sub- Clause 'c' hereunder.
- c) Where the extra works are not of similar character and/or executed under similar conditions as aforesaid or where the omissions vary the conditions under which any remaining items or works are carried out, then the Contractor/ Vendor shall within 7 days of the receipt of the letter of acceptance inform the SBI of the rate which he intends to charge for such items of work, duly supported by analysis of the rate or rates claimed and the SBI shall fix such rate or prices as in the circumstances in its opinion are reasonable and proper, based on the market rate.
- d) Where extra work cannot be properly measured or valued the Contractor/ Vendor shall be allowed day work prices at the net rates stated in the tender, of the BOQ or, if not, so stated then in accordance with the local day work rates and wages for the district; provided that in either case, vouchers specifying the daily time (and if required by the SBI) the workman's name and materials employed be delivered for verifications to the Architect /consultant at or before the end of the week following that in which the work has been executed.
- e) It is further clarified that for all such authorized extra items where rates cannot be derived from the tender, the Contractor/ Vendor shall submit rates duly supported by rate analysis worked on the 'market rate basis for material, labour hire / running charges of equipment and wastages etc. plus 15% towards establishment charges, Contractor/ Vendor's overheads and profit. Such items shall, not be eligible for escalation.

22.0 Final measurement

The measurement and valuation in respect of the contract shall be completed within one months of the virtual completion of the work.

23.0 Virtual Completion Certificate (VCC)

On successful completion of entire works covered by the contract to the full satisfaction of the SBI,

the Contractor/ Vendor shall apply to SBI for completion certificate.

Upon the satisfactory fulfillment by the Contractor/ Vendor as stated above, the Contractor/ Vendor is entitled to apply to the SBI of satisfactory completion of work. Relative to which the completion certificate has been sought, the SBI shall within fourteen (14) days of the receipt of the application for completion certificate, issue a VCC in respect of the work for which the VCC has applied.

This issuance of a VCC shall not be without prejudice to the SBI's rights and Contractor/ Vendor liabilities under the contract including the Contractor/ Vendor's liability for defects liability nor shall the issuance of VCC in respect of the works or work at any site be construction as a waiver of any right or claim of the SBI against the Contractor/ Vendor in respect of or work at the site and in respect of which the VCC has been issued.

24. Insurance of works

Without limiting his obligations and responsibilities under the contract the Contractor/ Vendor shall insure in the joint names of the SBI and the Contractor/ Vendor against all loss of damages from whatever cause arising other than the excepted risks, for which he is responsible under the terms of contract and in such a manner that the SBI. and Contractor/ Vendor are covered for the period stipulated in clause 28 of GCC and are also covered during the period of maintenance for loss or damage arising from a cause, occurring prior to the commencement of the period of maintenance and for any loss or damage occasioned by the Contractor/ Vendor in the course of any operations carried out by him for the purpose of complying with his obligations under clause.

- a) The Works for the time being executed to the estimated current Contract value thereof, or such additional sum as may be specified together with the materials for incorporation in the works at their replacement value.
- b) Such insurance shall be affected with an insurer and in terms approved by the SBI which approval shall not be unreasonably withheld and the Contractor/ Vendor shall whenever have required produce to the SBI the policy of insurance and the receipts for payment of the current premiums.

25.0 Damage to persons and property

The Contractor/ Vendor shall, except if and so far as the contract provides otherwise indemnify the SBI against all losses and claims in respect of injuries or damages to any person or material or physical damage to any property whatsoever which may arise out of or in consequence of the execution and maintenance of the works and against all claims proceedings, damages, costs, charges and expenses whatsoever in respect of or in relation thereto except any compensation of damages for or with respect to:

- a) The permanent use or occupation of land by or any part thereof.

- b) The right of SBI to execute the works or any part thereof on, over, under, in or through any lands.
- c) Injuries or damages to persons or properties which are unavoidable result of the execution or maintenance of the works in accordance with the contract
- d) Injuries or damage to persons or property resulting from any act or neglect of the SBI their agents, employees or other Contractor/ Vendors not being employed by the Contractor/ Vendor or for or in respect of any claims, proceedings, damages, costs, charges and expenses in respect thereof or in relation thereto or where the injury or damage was contributed to by the Contractor/ Vendor, his servants or agents such part of the compensation as may be just and equitable having regard to the extent of the responsibility of the SBI, their employees, or agents or other employees, or agents or other Contractor/ Vendors for the damage or injury.

26.0 Contractor/ Vendor to indemnify SBI

The Contractor/ Vendor shall indemnify the SBI. against all claims, proceedings, damages, costs, charges and expenses in respect of the matters referred to in the provision sub-clause 25 of this clause.

27.0 Contractor/ Vendor's superintendence

The Contractor/ Vendor shall fully indemnify and keep indemnified the SBI against any action, claim, or proceeding relating to infringement or use of any patent or design or any alleged patent or design rights and shall pay any royalties which may be payable in respect of any article or part thereof included in the contract. In the event of any claim made under or action brought against SBI. in respect of such matters as aforesaid the Contractor/ Vendor shall be immediately notified thereof and the Contractor/ Vendor shall be at liberty, at his own expenses to settle any dispute or to conduct any litigation that may arise there from, provided that the Contractor/ Vendor shall not be liable to indemnify the SBI. if the infringement of the patent or design or any alleged patent or design right is the direct result of an order passed by the SBI in this behalf.

Third Party Insurance

Before commencing the execution of the work the Contractor/ Vendor but without limiting his obligations and responsibilities under clause 24.0 of GCC shall insure against his liability for any material or physical damage, loss, or injury which may occur to any property including that of SBI., or to any person, including any employee of the SBI, by or arising out of the execution of the works or in the carrying out of the contract, otherwise than due to the matters referred to in the provision to clause 24.0 thereof.

Minimum amount of Third Party Insurance

Such insurance shall be affected with an insurer and in terms approved by the SBI whose approval shall not be reasonably withheld and for at least the amount stated below. The Contractor/ Vendor shall, whenever required, produce to the SBI the policy or policies of insurance cover and receipts for payment of the current premiums.

The minimum insurance cover for physical property, injury, and death is Rs.5 Lakh per

occurrence with the number of occurrences limited to four. After each occurrence Contractor/ Vendor will pay additional premium necessary to make insurance valid for four occurrences always.

Accident or Injury to workman:

i. The SBI shall not be liable for or in respect of any damages or compensation payable at law in respect or in consequence of any accident or injury to any workmen or other person in the employment of the Contractor/ Vendor or any sub- Contractor/ Vendor, save and except an accident or injury resulting from any act or default of the SBI or their agents, or employees. The Contractor/ Vendor shall indemnify and keep indemnified SBI against all such damages and compensation, save and except as aforesaid, and against all claims, proceedings, costs, charges and expenses whatsoever in respect thereof or in relation thereto.

ii. Insurance against accidents etc. to workmen

The Contractor/ Vendor shall insure against such liability with an insurer approved by the SBI during the whole of the time that any persons are employed by him on the works and shall, when required, produce to the architect / consultant such policy of insurance and receipt for payment of the current premium. Provided always that, in respect of any persons employed by any sub-Contractor/ Vendor the Contractor/ Vendor's obligation to insured as aforesaid under this sub-clause shall be satisfied if the sub-Contractor/ Vendor shall have insured against the liability in respect of such persons in such manner that SBI. is indemnified under the policy but the shall require such sub-Vendor to produce to the SBI when such policy of insurance and the receipt for the payment of the current premium.

iii. Remedy on Contractor/ Vendor's failure to insure

If the Contractor/ Vendor fails to effect and keep in force the insurance referred to above or any other insurance which he may be required to effect under the terms of contract, then and in any such case the SBI may affect and keep in force any such insurance and pay such premium or premiums as may be necessary for that purpose and from time to time deduct the amount so paid by the SBI as aforesaid from any amount due or which may become due to the Contractor/ Vendor or recover the same as debt from the Contractor/ Vendor.

iv. Without prejudice to the others rights of the SBI against Contractor/ Vendors. In respect of such default, the employer shall be entitled to deduct from any sums payable to the Contractor/ Vendor the amount of any damages costs, charges, and other expenses paid by the SBI and which are payable by the Contractor/ Vendors under this clause. The Contractor/ Vendor shall upon settlement by the Insurer of any claim made against the insurer pursuant to a policy taken under this clause, proceed with due diligence to rebuild or repair the works destroyed or damaged. In this event all the monies received from the Insurer in respect of such damage shall be paid to the Contractor/ Vendor and the Contractor/ Vendor shall

not be entitled to any further payment in respect of the expenditure incurred for rebuilding or repairing of the materials or goods destroyed or damaged.

30.0 Commencement of Works:

The date of commencement of the work will be reckoned as the date of execution of agreement with Circles SBI.

31.0 Time for completion

Time is essence of the contract and shall be strictly observed by the Contractor/ Vendor. The entire work shall be completed within a period of **45 calendar days** from the date of commencement.

32.0 Extension of time

If, the work be delayed for reasons beyond the control of the Contractor/ Vendor, the Contractor/ Vendor may submit a recommendation to the SBI to grant a fair and reasonable extension of time for completion of work as per the terms of contract. If the Contractor/ Vendor needs an extension of time for the completion of work or if the completion of work is likely to be delayed for any reasons beyond the due date of completion as stipulated in the contract, the Contractor/ Vendor shall apply to the SBI. in writing at least 30 Days before the expiry of the scheduled time and while applying for extension of time he shall furnish the reason in detail and his justification if any, for the delays in the prescribed format for granting extension of time. While granting extension of time the Contractor/ Vendor shall be informed the period extended time which will qualify for levy of liquidated damages. For the balance period in excess of original stipulated period and duly sanctioned extension of time by the provision of liquidated damages as stated under clause 8.0 shall become applicable. Further the contract shall remain in force even for the period beyond the due date of completion irrespective whether the extension is granted or not.

33.0 Rate of progress

Whole of the materials, plant and labour to be provided by the Contractor/ Vendor and the mode, manner and speed of execution and maintenance of the works are to be of a kind and conducted in a manner to the satisfaction of the SBI Should the rate of progress of the work or any part thereof be at any time be in the opinion the SBI too Slow to ensure the completion of the whole of the work the prescribed time or extended time for completion, the SBI shall thereupon take such steps as considered necessary to expedite progress so as to complete the works by the prescribed time or extended time. Such communications from the SBI neither shall relieve the Contractor/ Vendor from fulfilling obligations under the contract nor he will be entitled to raise any claims arising out of such directions.

34.0 Work during nights and holidays

Subject to any provision to the contrary contained in the contract no permanent work shall, as herein provided, be carried on during the night or on holidays without the permission in writing of the SBI, except when the work is unavoidable or absolutely necessary for the saving of life or property or for the safety of the work in which case the Contractor/ Contractor/ Vendor shall immediately advise the SBI. However, the provisions of the clause shall not be applicable in the case of any work which becomes essential to carry by rotary or double shifts in order to achieve the progress and quality of the part of the works being technically required / continued with the prior approval of the SBI at no extra cost.

All work at night after obtaining approval from competent authorities of SBI shall be carried out without unreasonable noise and disturbance.

35.0 No compensation or restrictions of work

If at any time after acceptance of the tender, SBI shall decide to abandon or reduce the scope of work for any reason whatsoever and hence not required the whole or any part of the work to be carried out. SBI shall give notice in writing to that effect to the Contractor/ Vendor and the Contractor/ Vendor shall act accordingly in the matter. The Contractor/ Vendor shall have no claim to any payment of compensation or otherwise whatsoever on account of any profit or advantage which he might have derived from the execution of the Work fully but which he did not derive in consequence of the foreclosure of the whole or part of the work.

Provided that the Vendor shall be paid the charges on the cartage of only materials actually and bona-fide brought to the site of the work by the Contractor/ Vendor and rendered surplus as a result of the abandonment, curtailment of the work or any portion thereof and then taken back by the Vendor, provided however that the SBI shall have in such cases the option of taking over all or any such materials at their purchase price or a local current rate whichever is less.

“In case of such stores having been issued from SBI stores and returned by the Vendor to stores, credit shall be given to him at the rates not exceeding those at which were originally issued to the Vendor after taking into consideration and deduction for claims on account of any deterioration or damage while in the custody of the Contractor/ Vendor and in this respect the decision of Architect / consultant shall be final.

36.0 Suspension of work

- i) The Contractor/ Vendor shall, on receipt of the order in writing of SBI (whose decision shall be final and binding on the Contractor/ Vendor) suspend the progress of works or any part thereof for such time and in such manner as SBI may consider necessary so as not to cause any damage or injury to the work already done or endanger the safety thereof for any of following reasons:
 - a) On account any default on the part of the Contractor/ Vendor, or
 - b) For proper execution of the works or part thereof for reasons other than the default

the Vendor/ Contractor, or

- c) For safety of the works or part thereof.

The Contractor / Vendor shall, during such suspension, properly protect and secure the works the extent necessary and carry out the instructions given in that behalf by the SBI.

- ii) If the suspension is ordered for reasons (b) and (c) in sub-para (i) above:

The Contractor/ Vendor shall be entitled to an extension of time equal to the period of every such suspension. No compensation whatsoever shall be paid on this account.

37.0 **Action when the whole security deposit is forfeited**

In any case in which under any clause or clauses of this contract, the Contractor/ Vendor shall have rendered himself liable to pay compensation amounting to the whole of his security deposit the SBI shall have the power to adopt any of the following course as they may deem best suited to the interest of the SBI:

- a) To rescind the contract (of which rescission notice in writing to the Contractor/ Vendor by SBI shall be conclusive evidence) and in which case the security, deposit of the Contractor/ Vendor shall be forfeited and be absolutely at the disposal of SBI
- b) To employ labour paid by the SBI and to supply materials to carry out the work, or part of the work, debiting the Contractor/ Vendor with the cost of the labour and materials cost of such labour and materials (as worked out by the SBI shall final and conclusive against the Contractor/ Vendor) and crediting him with the value of the work done, in all respects in the same manner and at the same manner and at the same rates as if it had been carried out by the Contractor/ Vendor under the terms of this contract certificate of SBI as to the value of work done shall be final conclusive against the Contractor/ Vendor.
- c) To measure up the work of the Contractor/ Vendor, and to take such part thereof as shall be unexecuted, out of his hands, and to give it to another Contractor/ Vendor to complete, in which case any expenses which may be incurred in excess of the sum which would have been paid to the original Contractor/ Vendor, if the whole work had been executed by him (The amount of which excess the certificates in writing of the SBI shall final and conclusive) shall be borne by original Contractor/ Vendor and may be deducted if any money due to him by SBI under the contract or otherwise, or from his security deposit or the proceeds of sale thereof, or sufficient part thereof.

In the event of any of above courses being adopted by the SBI the Contractor/ Vendor shall have no claim to compensation for any loss sustained by him by reasons of his having purchased or procured any material or entered into any engagements or make any advances on account of, or with a view to the execution of the work or the performance of the contract and in case the contract shall be rescind under the provision aforesaid, the Contractor/ Vendor shall not be entitled to recover or to be paid any sum or any work thereto for actually performed under this contract, unless, and until SBI will have certified in writing the performance of such work and the value

payable in respect thereof, and he shall only be entitled to be paid the value so certified.

38.0 Owner's right to terminate the contract

If the Contractor/ Vendor being an individual or a firm commit any 'Act of insolvency' or shall be adjusted an insolvent or being an incorporated company shall have an order for compulsory winding up voluntarily or subject to the supervision of Govt. and of the Official Assignee of the liquidator in such acts of insolvency or winding up shall be unable within seven days after notice to him to do so, to show to the reasonable satisfaction of the SBI that he is able to carry out and fulfill the contract, and to dye security therefore if so required by the SBI

Or if the Contractor/ Vendor (whether an individual firm or incorporated Company) shall suffer execution to be issued or shall suffer any payment under this contract to be attached by or on behalf of any of the creditors of the Contractor/ Vendor.

Or shall assign or sublet this contract without the consent in writing of the SBI or shall charge or encumber this contract or any payment due to which may become due to the Contractor/ Vendor there under:

- a) has abandoned the contract; or
- b) has failed to commence the works or has without any lawful excuse under these conditions suspended the progress of the works for 14 days after receiving from the SBI written notice to proceed, or
- c) *has failed to proceed with the works with such diligence and failed to make such due progress as would enable the works to be completed within the time agreed upon, or has failed to remove the materials from the site or to pull down and replace work within seven days after written notice from the SBI that the said materials were condemned and rejected by the SBI under these conditions; or has neglected or failed persistently to observe and perform all or any of the acts matters or things by this contract to be observed and performed by the contactor for seven days after written notice shall have been given to the Contractor/ Vendor to observe or perform the same or has to the detriment of good workmanship or in defiance of the SBI to the contrary subject any part of the contract.*

Then and in any of said cases the SBI may not withstanding any previous waiver, after giving seven days' notice in writing to the Contractor/ Vendor, determine the contract, but without thereby affecting the powers of the SBI or the obligation and liabilities of the Contractor/ Vendor the whole of which shall continue in force as fully as if the contract had not been determined and as if the works subsequently had been executed by or on behalf of the Contractor/ Vendor. And, further the SBI or their employees may enter upon and take possession of the work and all plants, took scaffoldings, materials, sheds, machineries lying upon the premises or on the adjoining lands or roads use the same by means of their own employees or workmen in carrying on and completing the work or by engaging any other Contractor/ Vendors or persons to the work and the Contractor/ Vendor shall not in any was interrupt or do any act, matter or thing to prevent or hinder such other Contractor/ Vendor or other persons employed for complement and finishing

or using the materials and plant for the works.

When the works shall be completed or as soon thereafter as convenient to the SBI a notice in writing will be given to the Contractor/ Vendor to remove his surplus materials and plants and should the Contractor/ Vendor fail to do so within 14 days after receive thereof by him the SBI sell the same by publication, and after due publication, and shall, adjust the amount realized by such auction. The Contractor/ Vendor shall have no right to question any of the act of the SBI incidental to the sale of the materials etc.

39.0 Certificate of payment

The contractor shall be entitled under the certificates to be issued by the Architect / consultant to the contractor within 10 working days from the date of certificate to payment from SBI from time to time. The SBI shall recover the statutory recovering other dues including the retention amount from the certificate of payment.

Provided always that the issue of any certificate by the Architect / consultant during progress of works or completion shall not have effect as certificate of satisfaction relieve the contractor from his liability under clause.

The Architect / consultant shall have power to withhold the certificate if the work or in part thereof is not carried out to their satisfaction.

The Architect / consultant may by any certificate make any corrections required previous certificate.

The SBI shall modify the certificate of payment as issued by the architect / consultant from time to time while making the payment

The contractor shall submit interim bills only after taking actual measurements and properly recorded in the Measurement books

The Contractor shall not submit interim bills when the approximate value of work done as specified in NIT. As per profile of work and satisfactory performance by vendor Decision of interim payment if any shall be within discretion of Bank and which shall be binding to vendor.

The final bill may be submitted by contractor within a period of one month from the date of virtual completion and Architect / consultant shall issue the certificate of payment within a period of two months. The SBI shall pay the amount within a period of three months from the date of issue of certificate provided there is no dispute in respect of rates and quantities.

The contractor shall submit the interim bills in the prescribed format with all details. After successful completion of work, the Contractor/ Vendor shall prepare separate bills for each branch/office / ATM / site and submit the branch-wise Tax / Invoices / Bills along with specified **5 to 10 years Warrantee on Company Warrantee Cards / on**

Rs.500/- Non-Judicial Stamp paper for Supply of Furniture/waterproofing or other similar works along with a certificate/acknowledgement certifying completion of work by SBI or their authorized representative.

No advance on materials / plant / machinery or mobilization advance shall be paid in any circumstances.

The SBI shall recover the statutory recoveries viz. TDS, retention and other dues, if any, as per contractual provisions.

The SBI shall have power to withhold the payment if the work or part thereof is not carried out to their satisfaction.

40 A. Settlement of Disputes and Arbitration

Except where otherwise provided in the contract all questions and disputes to the meaning of the specifications, design, drawings and instructions herein before mentioned and as to the quality of workmanship or materials used on the work or as to any other question, claim, right, matter or thing whatsoever in any way arising out of or relating to the contract, designs, drawings specifications, estimates, instructions orders or these conditions or otherwise concerning the work or the execution or failure to execute the same whether arising during the progress of the work or after the cancellation, termination, completion or abandonment thereof shall be dealt with as mentioned hereinafter:

If the contractor considers that he is entitled to any extra payment or compensation in respect of the works over and above the amounts admitted as payable by the Architect or in case the contractor wants to dispute the validity of any deductions or recoveries made or proposed to be made from the contractor raise any dispute, the contractor shall forthwith give notice in writing of his claim, or dispute to **Regional Manager I, State Bank of India, Regional Business Office - I, BSNL-CTTC Building, D-Road, Satpur- 422 007** and endorse a copy of the same to the Architect, within 30 days from the date of disallowance thereof or the date of deduction or recovery. The said notice shall give full particulars of the claim, grounds on which it is based and detailed calculations of the amount claimed and the contractor shall not be entitled to raise any claim nor shall the SBI be in any way liable in respect of any claim by the contractor unless notice of such claim shall have been given by the contractor to **Regional Manager I, State Bank of India, Regional Business Office - I, BSNL-CTTC Building, Satpur-422 007** in the manner and within the time as aforesaid. The Contractor shall be deemed to have waived and extinguished all his rights in respect of any claim not notified to **Regional Manager I, State Bank of India, Regional Business Office - I, BSNL-CTTC Building, Satpur- 422 007** in writing in the manner and within the time aforesaid.

B. Settlement of Disputes and Arbitration

Settlement of Disputes and Arbitration:

Regional Manager, State Bank of India, Regional Business Office - I, BSNL-CTTC Building, Satpur-422 007 give his decision in writing on the claims notified by the receipt of the contractor may within 30 days of the receipt of the decision of the Submit his claims to the conciliating authority namely the **DGM (B&O), State Bank of India, ADMIN office, First Floor, BSNL-CTTC Building, Plot No.45-47, D-Road, MIDC, Satpur, Nashik-422 007** for conciliation along with all details and copies of correspondence exchanged between him and the SBI.

If the conciliation proceedings are terminated without settlement of the disputes, the contractor shall, within a period of 30 days of termination thereof shall give a notice to the concerned DGM (B&O), of the SBI for appointment of an arbitrator to adjudicate the notified claims falling which the claims of the contractor shall be deemed to have been considered absolutely barred and waived.

Except where the decision has become final, binding and conclusive in terms of the contract, all disputes or differences arising out of the notified claims of the contractor as aforesaid and all claims of the SBI shall be referred for adjudication through arbitration by the Sole Arbitrator appointed by the DGM (B&O), and who will be of Deputy General Manager rank. It will also be no objection to any such appointment that the Arbitrator so appointed is a SBI, Officer and that he had to deal with the matters to which the Contract relates in the course of his duties as SBI, Officer. If the arbitrator so appointed is unable or unwilling to act or resigns his appointment or vacates his office due to any reason whatsoever another sole arbitrator shall be appointed in the manner aforesaid by the said DGM (B&O) of the SBI Such person shall be entitled to proceed with the reference from the stage at which it was let by his predecessor.

It is a term of this contract that the party invoking arbitration shall give a list of disputes with amounts claimed in respect of each dispute along with the notice for appointment of arbitrator.

It is also a term of this contract that no person other than a person appointed by such Chief General Manager as aforesaid should act as arbitrator. The conciliation and arbitration shall be conducted in accordance with the provisions of the Arbitration & Conciliation Act 1996 or any or any accordance modification or reenactment thereof and the rules made there under.

It is also a term of the contract that if any fees are payable to the Arbitrator these shall be paid equally by both the parties. However, no fees will be payable to the arbitrator if he is a SBI Officer.

It is also a term of the contract that the Arbitrator shall be deemed to have entered on the reference on the date he issues notice to both the parties calling them to submit their statement of claims and counter statement of claims. The venue of the arbitration shall be such place as may be fixed by the arbitrator in his sole discretion. The fees, if any of the arbitrators shall, if required to be paid before the award is made and published, be paid half and half by each of the parties. The Cost of the reference and of the award (including the fees, if any of the arbitrator) shall be in the discretion of the arbitrator who may direct to any by whom and in what manner, such costs or any part thereof, shall be paid and fix or settle the amount of costs to be so paid.

41.0 Method of measurement

Unless otherwise mentioned in the schedule of quantities or in mode of measurement, the measurement will be on the net quantities or work produced in accordance with up

to date rules laid down by the Bureau of Indian Standards. In the event any dispute / disagreement the decision of the SBI shall be final and binding on the corrector.

Maintenance of registers

The contractor shall maintain the following registers as per the enclosed perform at site of work and should produce the same for inspection of STATE BANK OF INDIA /Architect / consultant whenever desired by them. The contractor shall also maintain the records / registers as required by the local authorities / Govt. from time to time.

- i) Register for secured advance
- ii) Register for hindrance to work
- iii) Register for running account bill
- iv) Register for labour

Force Majeure

Neither Contractor/ Vendor nor SBI shall be considered in default in performance of the obligations if such performance is prevented or delayed by events such as but not war, hostilities revolution, riots, civil commotion, strikes, lockout, conflagrations, epidemics, accidents, fire, storms, floods, droughts, earthquakes or ordinances or any act of or for any other cause beyond the reasonable control of the party affected or prevents or delayed. However, a notice is required to be given within 30 days from the happening of the event with complete details, to the other party to the contract.

As soon as the cause of force majeure has been removed the party whose ability perform its obligations has been affected, shall notify the other of such cessation and the actual delay incurred in such affected activity adducing necessary evidence in support thereof.

From the date of occurrence of a case of force majeure obligations of the party affected shall be suspended during the continuance of any inability so caused. With the caused itself and inability resulting there from having been removed, the agreed time completion of the respective obligations under this agreement shall stand extended a period equal to the period of delay occasioned by such events.

Should one or both parties be prevented from fulfilling the contractual obligations by state of force majeure lasting to a period of 6 months or more the two parties, shall mutually decide regarding the future execution of this agreement.

44.0 Local laws, Acts Regulations:

The Contractor/ Vendor shall strictly adhere to all prevailing labour laws including the contract labour (regulation and abolition act of 1970) and other safety regulations. The Contractor/ Vendors should comply with the provision of all labour legislation including the latest requirements of the Acts, laws, any other regulations that are applicable to the execution of the project.

45.0 Accidents

The Contractor/ Vendor shall immediately on occurrence of any accident at or about the site or in connection with the execution of the work report such accident to the architect / consultant. The Contractor/ Vendor shall also such report immediately to the competent authority whenever such report is required to be lodged by the law and take appropriate actions thereof.

SPECIAL CONDITION OF CONTRACT

1. The Technical Bid should contain the following: -
 - a. Technical Bid duly signed and sealed on each page.
 - b. Banker's Cheque/Demand Draft of Earnest Money deposit.
 - c. If any, The Authorization Certificate issued by the Bank's approved Principal Manufacturer only certifying that the tenderer is an Authorized Converter/Agency of their Company and they have been specifically authorized by them (i.e. OEM) to participate in the bidding process of SBI.
 - d. If any, An undertaking from the Bank's approved OEM, in original, to the effect that in case their Authorised Agency/Converter is not able to perform contractual obligations for the project during the contract period, the Original Manufacturer shall own full responsibility to comply all contractual obligations relating the captioned work of SBI at their own (i.e. OEM's) risk cost and consequences.

The technical bid not accompanied by abovementioned any one or more documents shall be treated as non-responsive bid and the same shall be summarily disqualified. Moreover, such bidders shall not be allowed to participate in the submission of Indicative Price bidding followed by the E-reverse auction. No correspondence shall be entertained in this regard.

2. Taxes, duties, levies etc.:

The rates quoted shall be inclusive of all taxes, duties, levies, royalties, fees, cess or charges in respect of the works but excluding GST which shall be payable over and above the approved rates as per actual. Variation of taxes, duties, fees, levies etc.(excluding GST) if any, till completion of work shall be deemed to be included in the quoted rates and no extra claim on this account in any case will be entertained. If a new tax or duty or levy or cess or royalty or octroi is imposed under as statutory law during the currency of contract the same shall be borne by the Contractor/ Vendor. **GST will however be paid by the SBI as applicable.**

3. The Contractor/ Vendor shall study the schedule of items, technical specifications, drawings, design, etc. for its sufficiency considering all the regulations of local authorities and supply company and code of standard as applicable at the time of submitting the tender and shall bring to the notice of bank, addition or deletion, if any, in writing before due date of submission of tender.

4. Acceptance of tender

The SBI shall have the right to reject any or all tenders without assigning any reason. They are not to bind to accept the lowest or any tender and the tenderer or tenderers shall have no right to question the acts of the SBI However adequate transparency would be maintained by the SBI.

5. Dimensions and levels

All dimensions and levels shown on the drawings shall be verified by the contractor and the site and he will be held responsible for the accuracy and maintenance of. All the dimensions and the levels. Figured dimensions are in all cases to be accepted and dimension shall be scaled. Large scale details shall take precedence over small scale drawings. In case of discrepancy the contractor shall ask for clarification from the Architect / consultant before proceeding with the work.

6. Notice of operation

The contractor shall not carry out any important operation without the Consent in with from the Architect / consultant:

7. Construction records

The contractor shall keep and provide to the Architect / consultant full and accurate records of the dimensions and positions of all new work and any other information necessary to prepare complete drawings recording details of the work as construction.

8. Safety of adjacent structures and trees

The contractor shall provide and erect to the approval of the Architect / consultant supports as may be required to protect effectively all structures and protective give to trees, which may be endangered by the execution of the works or otherwise such permanent measures as may be required by the Architect to protect the tree structures.

9. Temporary works

Before any temporary works are commenced the contractor shall submit at least in advance to the architect / consultant for approval complete drawings of all temporary works he may require for the execution of the works. The contractor shall carry out the modifications relating to strength, if required by the architect / consultant may require in accordance with the conditions of contract at his own cost the contractor shall be solely responsible for the stability and safety of all temporary works and unfinished works and for the quality of the permanent works resulting from the arrangement eventually adopted for their execution.

10. Water power and other facilities

a) The rate quoted by the contractor shall include all expenses that are required for providing all the water required for the work and the contractor shall make his own arrangements for the supply of good quality water suitable for the construction and good quality drinking water for their workers If necessary the contractor has to sink a tube well / open well and bring water by means of tankers at his own cost for the purpose The STATE BANK OF INDIA will not be liable to pay any charges in connection with the above

b) The rate quoted in the tender shall include the expenses for obtaining and maintaining power connections and shall pay for the consumption charges

c) The contractors for other trades directly appointed by the STATE BANK OF INDIA shall be entitled to take power and water connections from the temporary water and power supply obtained by the contractor. However, the concerned contractor shall make their own arrangements to draw the supply and pay directly the actual consumption charges at mutually agreed rates between them. All municipal charges for drainage and water connection for Construction purposes shall be borne by the contractor and charges payable for permanent connections, if any, shall be initially paid by the contractor and the SBI will reimburse the amount on production of receipts.

d) The SBI as well as the Architect / consultant shall give all possible assistance to the Contractor's to obtain the requisite Permission from the various authorities, but the responsibility for obtaining the same in time shall be of the contractor.

11. Facilities for contractor's employees

The contractor shall make his own arrangement for the housing and welfare of his staff and workmen including adequate drinking water facilities. The contractor shall also make the arrangements at his own cost for transport where necessary for his staff and workmen to and from site of work at his own cost.

12. Lighting of works

The contractor shall at all times provide adequate and approved lighting as required for the proper execution and supervision and inspection of work.

13. Firefighting arrangements

i) The contractor shall provide suitable arrangement for firefighting at his own cost. This purpose he shall provide requisite number of fire extinguishers and adequate number of buckets, some of which are to be always kept filled with sand and some with water. This equipment shall be provided at suitable prominent and easily accessible place and shall be properly maintained.

ii) Any deficiency in the fire safety or unsafe conditions shall be corrected by the contractor at his own cost and, to the approval of the relevant authorities. The contractor makes the following arrangements at his own cost but not limited to the following:

- a) Proper handling, storage and disposal of combustible materials and waste.
- b) Work operations which can create fire hazards.
- c) Access for fire-fighting equipment.
- d) Type, number and location of containers for the removal of surplus materials and rubbish.
- e) Type, size, number and location of fire extinguishers or other fire fighting equipment.
- f) General house keeping

14. Site order book

A site order book shall be maintained at site for the purpose of quick communication between the Architect / Consultant. Any communication relating to the work may be conveyed through records in the site order book. Such a communication from one party to the other shall be deemed to have been adequately served in terms of contract. Each site order book shall have machine numbered pages in triplicate and shall be carefully maintained and preserved by the contractor and shall be made available to the architect / consultant as and when demanded. Any instruction which the architect / consultant may like to issue to the contractor or the contractor may like to bring to the architect / consultant two copies of such instructions shall be taken from the site order book and one copy will be handed over to the party against proper acknowledgment and the second copy will be retained for their record.

15. Temporary fencing/ barricading

The contractor shall provide and maintain a suitable temporary fencing / barricading and gates at his cost to adequately enclose all boundaries of the site for the protection of the public and for the proper execution and security of the work and in accordance with the requirement of the architect / consultant and regulations of local authorities. These shall be altered, relocated and adopted from time to time as necessary and removed on completion of the work.

16. Site meetings

Site meetings will be held to review the progress and quality evaluation. The contractor shall depute a senior representative along with the site representative and other staff of approved sub-contractors and suppliers as required to the site meetings and ensure all follow up actions. Any additional review meetings shall be held if required by the architect/ consultant. -

17. Disposal of refuse

The contractor shall cart away all debris, refuse etc. arising from the work from the site and deposit the same as directed by the architect / consultant at his own cost. It is the responsibility of the contractor to obtain from the local authorities concerned to the effect that all rubbish arising out of contractor's activities at the construction site or any other off-site activities borrow pits has been properly disposed off.

18. Contractor to verify site measurement

The contractor shall check and verify all site measurements whenever requested other specialists contractors or other sub-contractors to enable them to prepare the own shop drawing and pass on the information with sufficient promptness as will in any way delay the works.

19. Displaying the name of the work

The contractor shall put up a name board of suitable size as directed by the architect/ consultant indicating therein the name of the project and other details as given by the

architect/consultant at his own cost and remove the same on completion of work.

20. As built drawings

- i) For the drawings issued to the contractor by the Architect / Consultant. The architect Consultant will issue two sets of drawings to the Contractor for the items for some changes have been made. From the approved drawings as instructed by the STATE BANK OF INDIA / Architect / Consultant. The contractor will make the changes made on these copies and return these copies to the architect / Consultant for their approval. In cases revision is required or the corrections are not properly marked the architect / Consultant will point out the discrepancies to the contractor. The contractor will have to incorporated these corrections and / or attend to discrepancies either on copies as directed by the architect / consultant and resubmit to him for approval. The architect / consultant will return one copy duly approved by him.
- ii) For the drawings prepared by the contractor

The contractor will modify the drawing prepared by him wherever the changes made by the STATE BANK OF INDIA / architect / consultant. And submit two copies of such modified drawings to the architect/ consultant for approval. The architect / consultant will return one copy of the approved drawing to the contractor.

21. Approved make

The contractor shall provide all materials from the list of approved makes at his own cost and also appoint the specialized agency for the waterproofing anti-termite, aluminum doors and windows and any other item as specified in the tender. The architect/consultant may approve any make / agency within the approved list as given in the tender after inspection of the sample/mock up.

22. Procurement of materials

The contractor shall make his own arrangements to procure all the required materials for the work. All wastages and losses in weight shall be to the contractors account

23. Excise duty, taxes, levies etc.;

The contractor shall pay and be responsible for payment of all taxes, duties, levies, royalties, fees, cess or charges in respect of the works including but not limited to sales tax, tax on works contract excise duty, and octroi, payable in respect of materials, equipment plant and other things required for the contract. All of the aforesaid taxes, duties, levies, fees and charges shall be to the contractor's account and the STATE BANK OF INDIA shall not be required to pay any additional or extra amount on this account. Variation of taxes, duties, fees, levies etc. if any, till completion of work shall be deemed to be included in the quoted rates and no extra amount on this account. Variation of taxes, duties, fees, levies etc. if any, till completion of work shall be deemed to be included in the quoted rates and no extra claim on this account will in any case be entertained. If a new tax or duty or levy or cess or royalty or octroi is imposed under as statutory law during the currency of contract the same shall be borne by the contractor.

24. Photographs:

- The Contractor shall at his own expense supply to the Architects with duplicate hard copies of large photographs not less than 25 cm. x 20 cm. (10" x 8") of the works, taken from two approved portions of each building, at intervals of not more than one months during the progress of the work or at every important stage of construction.
- In addition to above, the contractor shall be bound to submit adequate no. of site photographs along with each Running Bill for the project clearing showing major progress of work measured and claimed therein failing which the Architect/ STATE BANK OF INDIA may consider returning the Bill to the contractor and no claim for delay on this account will be entertained.

ARTICLES OF AGREEMENT

(On non-judicial Stamp Paper of Rs. 500/- or as per latest Govt. Rules)

ARTICLES OF AGREEMENT made the _____ date of _____ between STATE BANK OF INDIA, having its office at Mumbai hereinafter called "the Client" of the One Part and

WHEREAS the STATE BANK OF INDIA is desirous of

and has caused specifications describing the work to be done to be prepared by STATE BANK OF INDIA.

AND WHEREAS the said Drawings numbered _____ to _____ inclusive, the Specifications and the Schedule of Quantities have been signed by or on behalf of the parties hereto.

AND WHEREAS the Contractor has agreed to execute upon and subject to the Conditions set forth herein and to the Conditions set forth herein in the Special Conditions and in the Schedule of Quantities and Conditions of Contract (all of which are collectively hereinafter referred to as "the said conditions") the works shown upon the said Drawings and / or described in the said Specifications and included in the Schedule of Quantities at the respective rates therein set forth amounting to the sum as therein arrived at or such other sum as shall become payable there under (hereinafter referred to as "the said Contract Amount.")

NOW IT IS HEREBY AGREED AS FOLLOWS:

- 1) In consideration of the said Contract Amount to be paid at the times and in the manner set forth in the said Conditions, the Contractor shall upon and subject to the said Conditions execute and complete the work shown upon the said Drawings and described in the said Specifications and the priced Schedule of Quantities.
- 2) The Employer shall pay to the Contractor the said Contract Amount, or such other sum as shall become payable, at the times and in the manner specified in the said Conditions.
- 3) The term "The Architects" in the said Conditions shall mean the **STATE BANK OF INDIA**, or in the event of their ceasing to be the Architects for the purpose of this Contract for whatever reason, such other person or persons as shall be nominated for that purpose by the Employer, not being a person to whom the Contractor shall object for reasons considered to be sufficient by the Employer, PROVIDED ALWAYS that no person

or persons subsequently appointed to be Architects under this Contract shall be entitled to disregard or overrule any previous decisions or approval or direction given or expressed in writing by the outgoing Architects for the time being.

- 4) The said Conditions and Appendix thereto shall be read and construed as forming part of this Agreement, and the parties hereto shall respectively abide by submit themselves to the said Conditions and perform the Agreements on their part respectively in the said Conditions contained.
- 5) The Plans, Agreements and Documents mentioned herein shall form the basis of this Contract.
- 6) This Contract is neither a fixed lump-sum contract nor a piece work contract but a contract to carry out the work in respect of the entire building complex to be paid for according to actual measured quantities at the rates contained in the Schedule of Quantities and Rates or as provided in the said Conditions.
- 7) The Contractor shall afford every reasonable facility for the carrying out of all works relating to civil works, installation of lifts, Telephone, electrical installations, fittings air- conditioning and other ancillary works in the manner laid down in the said Conditions, and shall make good any damages done to walls, floors, etc. after the completion of his work.
- 8) The STATE BANK OF INDIA reserves to itself the right of altering the drawings and nature of the work by adding to or omitting any items of work or having portions of the same carried out without prejudice to this Contract.
- 9) Time shall be considered as the essence of this Contract and the Contractor hereby agrees to commence the work soon after the Site is handed over to him or from 14th day after the date of issue of formal work order as provided for in the said Conditions whichever is later and to complete the entire work within -- **days** subject to nevertheless the provisions for extension of time.
- 10) All payments by the SBI under this Contract will be made only at **Nashik**.
- 11) All disputes arising out of or in any way connected with this Agreement shall be deemed to have arisen at **Nashik** and only the Courts in **Nashik** shall have jurisdiction to determine the same.
- 12) That the several parts of this Contract have been read by the Contractor and fully understood by the Contractor.

IN WITNESS WHEREOF THE EMPLOYER and the Contractor have set their respective hands to these presents and two duplicates hereof the day and year first hereinabove written.

SIGNATURE CLAUSE

SIGNED AND DELIVERED by the

_____ By the
(Employer)

hand of Shri _____

(Name and Designation)

(Signature of Employer)

In the presence of :

1) Shri / Smt. _____

(Signature of Witness)

Address _____

(Witness)

SIGNED AND DELIVERED by the

_____ by the
(Contractor)

(Signature of Contractors)

in the presence of :

Shri / Smt. _____

(Signature of Witness)

Address _____

(Witness)

SAFETY CODE

1. First aid appliances including adequate supply of sterilized dressing and cotton wool shall be kept in a readily accessible place.
2. An injured person shall be taken to a public hospital without loss of time, in cases when the injury necessitates hospitalization.
3. Suitable and strong scaffolds should be provided for workmen for all works that cannot safely be done from the ground.
4. No portable single ladder shall be over 8 meters in length. The width between the side rails shall not be less than 30 cm. (clear) and the distance between two adjacent running shall not be more than 30 cm. When a ladder is used an extra mazdoor shall be engaged for holding ladder.
5. The excavated material shall not be placed within 1.5 meters of the edge of the trench half of the depth of trench whichever is more. All trenches and excavations shall be provided with necessary fencing and lighting.
6. Every opening in the floor of a building or in a working platform be provided with suitable means to prevent the fall of persons or materials by providing suitable fencing or railing whose minimum height shall be one meter.
7. No floor, roof or other part of the structure shall be so overloaded with debris or material as to render it unsafe.
8. Workers employed on mixing and handling material such as asphalt, cement, mortar, concrete and lime shall be provided with protective footwear and rubber hand gloves.
9. Those engaged in welding works shall be provided with welders' protective eye shield and gloves.
10. (i) No paint containing lead or lead products shall be used except in the form of paste readymade paint.
(ii) Suitable facemasks should be supplied for use by the workers when the paint applied in the form of spray or surface having lead paint dry rubbed and scrapped.
11. Overalls shall be supplied by the contractor to the painters and adequate facilities shall be provided to enable the working painters to wash during cessation of work.
12. Hoisting machines and tackle used in the works including their attachments anchor and supports shall be in perfect condition.
13. The ropes used in hoisting or lowering material or as a means of suspension shall be durable quality and adequate strength and free from defects.

(A) Contact Information

E-Procurement Technologies Ltd.	State Bank of India
<p>B-704, Wall Street - II, Opp. Orient Club, Nr. Gujarat College, Ahmedabad - 380 006. Gujarat State, India</p> <p>Tel.: +91 79 61200 579 580 567 569 566</p> <p>Mr.Nisarg Thakkar E-mail :nisarg.thakkar@auctiontiger.net Contact No :99044 06300</p>	<p>Regional Manager -I State Bank of India BSNL-CTTC Building, Nashik- 422 007</p> <p>Officer Name :Yogesh Hadole Department :Dy. Manager (Civil) Contact No : 7600056174</p>

APPENDIX HEREIN BEFORE REFERRED TO

- 1) Name of the organization Offering Contract : **Regional Manager -I
State Bank of India
BSNL-CTTC Building,
Nashik - 422007**
- 2) Consultants :
- 3) Site Address : **SBI SME NASHIK BRANCH, NASHIK**
- 4) Scope of Work : **Proposed Interior Furnishing Work of
SBI SME NASHIK BRANCH, NASHIK**
- 5) Name of the Contractor : _____

- 6) Address of the Contractor : _____

- 7) Period of Completion : within the stipulated period from the date
of Issue of work order.
- 8) Earnest Money Deposit : **Rs. 22,700.00/- (Rupees Twenty Two Thousand
Seven Hundred Only)** by means of Demand Draft /
Pay Order (Valid for a period of 90 Days from the last
date of submission of the tender) from any
scheduled Nationalized Bank drawn in favour of **SBI
payable at Nashik**
- 9) Retention Money : As per clause no. 1.4 of
General Conditions
- 10) Defects Liability Period : Twelve Months from the date of
Virtual Completion.
- 11) Insurance to be undertaken by the : 125% of Contract Value
Contractor at his cost (Contractor's all
risk policy)
- 12) Liquidated damages : 0.5% of the Contract amount shown in
the tender per week subject to max. 5%
of the contract value or actual final bill
value.

- 13) Value of Interim Bill(Min.) : **As specified in NIT**
- 14) Date of Commencement : From the date of work order issued to the Contractor/ or the day on which the Contractor is instructed to take possession of the site whichever is earlier.
- 15) Period of Final Measurement : 2 Months from the date of Virtual Completion Certificate (VCC) issued by the project Architect.
- 16) Initial Security Deposit : **2 % of contract amount including EMD**
- 17) Total Security Deposit : **5 % of the final bill amount or contract value**
- 18) Refund of Total Security Deposit : 50% of the Security Deposit shall be refunded to the Contractor on completion of the work/along with the final bill and balance refunded only after the Defect Liability Period is over.
- 19) Period for Honoring Certificate : One Month for RA. Bills
- 20) The final bill will be submitted by the Contractor within one month of the date fixed for completion work and the Bill shall be Certified within 3 Months from the date of receipt of final bill provided the bills are submitted with all pre-requisite documents/test reports etc. prescribed in the tender.

Signature of Tenderer.

Date:

PROFORMA FOR RUNNING A/C BILL

- i. Name of Contractor / Agency :
- ii. Name of Work :
- iii. Sl.No. of this Bill :
- iv. No. & Date of previous Bill :
- v. Reference to Agreement No. :
- vi. Date of Written order to commence :
- vii. Date of Completion as per Agreement :

S.No.	Item Description	Unit	Rate (Rs.)	As per Tender	
				Quantity	Amount (Rs.)
1	2	3	4	5	

Upto Previous R.A. Bill		Up Date (Gross		Present Bill		Remarks
Quantity	Amount (Rs.)	Quantity	Amount (Rs.)	Quantity	Amount (Rs.)	
6		7		8		9

Note: 1. If part rate is allowed for any items, it should be indicated with reasons for allowing such a rate.

2. If ad-hoc payment is made, it should be mentioned specifically.

Net Value since previous bill

CERTIFICATE

The measurements on the basis of which the above entries for the Running Bill No. -----
----- were made have been taken jointly on ----- and are recorded at pages
_____ to _____ of measurement book No.

Signature and date of Contractor Signature and date of Architects Signature and date of Site Engineer

Representative (Seal)

The work recorded in the above-mentioned measurements has been done at the site
satisfactorily as per tender drawings, conditions and specifications.

Architect

Signature and
date of Site Engineer

MEMORANDUM FOR PAYMENT

R/A BILL NO.

1.	Total value of work done since previous bill (A)	Rs. -----
2.	Total amount of secured advance due since Previous Bill (B)	Rs. -----
3.	Total amount due since Previous Bill (C) (A+B)	Rs. -----
4.	PVA on account of declaration in price of Steel, Cement and other materials and labour as detailed in separate statements enclosed.	Rs. -----
5.	Total amount due to the Contractor	Rs. -----

OBJECTIONS:

i)	Secured Advance paid in the previous R/A	Rs. -----
ii)	Retention money on value of works as per accepted tenders upto date amount Rs.	Rs. -----
	Less already recovered	Rs. -----
	Balance to be recovered	Rs. -----
iii)	Mobilization Advance, if any	
(a)	Outstanding amount (principal + interest) as on date	Rs. -----
(b)	To be recovered in this bill	Rs. -----
iii.	Any other Departmental materials cost to be recovered as per contract, if any	Rs. -----
iv.	Any other Departmental service charges to be recovered if any, as per contract (water, power etc.) enclose statement.	Rs. -----
	Total Deduction as per contract (F)	Rs. -----

Adjustment, if any ----- Rs.-----
Amount less received by contractor in--RA bill
(As per statement of Contractor)

P.V.A. Rs.-----

Total amount payable as per contract Rs.-----
(E+F+G)

(Rupees -----in words)

The bill amount to Rs.----- (both figures and words) has been scrutinized by us after due checking of the measurements of work as required and is recommended for payment.

Date:-----
Signature of Architect with Seal

The bill amount to Rs.----- certified by Consultant has been scrutinized by me after due test checking of measurements of works as required and is recommended for payment for an amount Rs.-----

Date:-----
Signature of Owners Engineer

STATUTORY DEDUCTION:

i)	Total Amount due (E)	Rs. -----
ii)	Less I.T. Payable	Rs. -----
iii)	Less S.T. Payable	Rs. -----
	Net Payable	Rs. -----

This figure given in the Memorandum for payable has been verified and bill passed for payment (in words and figures) -----

Date: -----
Signature of concern Official

TECHNICAL SPECIFICATION

SPECIFICATIONS OF MATERIALS TO BE USED

General:

This specifications are for the work to be executed items to be supplied and materials to be used in the works as shown and defined on the drawings and described here in all under the supervision and to the satisfaction of the architect / employer.

The workmanship is to be the best available and to a high standard. Use must be made of specialist tradesmen in all aspects of the works, and allowance must be made in the rates for doing so.

The materials and items to be provided by the contractor shall be the best of their respective kinds, approved by the architect in accordance with any samples, which may be submitted for approval, and generally in accordance with the specification. Where materials or products are specified in this specification and/ or bill of quantities by the name of the manufacture or the brand trade name or catalogue references the contractor will be required to obtain the approval of the architect/ employer before using a material or product other than the specified. The contractor shall produce all invoices, vouchers or receipted accounts for any materials of called upon to do so by the architect.

Sample of all material are to be submitted to the architect for his approval before the contractor orders or delivers in bulk to the site. Also, the contractor will be required to submit specimen finishes to colors, fabrics etc. For the approval of the architect before proceeding with the works. Should it be necessary to prepare shop drawings, then four copies of such drawings shall be submitted for the approval of the architect who will retain to copies, all at the contractors expenses.

Materials

The materials shall be of the best-approved quality obtainable and shall comply with the respective Indian standard specification.

If directed, materials shall be tested in any approved testing laboratory and the test certificates in original shall be submitted to the architect and the entire charges for repeated testes, if ordered shall be borne by the constructor.

It shall be obligatory for the contractor to furnish certificate, it demanded by the architect, from manufacturer of the material supplier that the work has been carried out by using their material and as per their recommendations.

All materials supplied by the employer / any other specialist firm shall be properly stores and the contractor shall be responsible for its safe custody until they are required on the works and till the completion of work.

Unless otherwise shown on the drawings or mentioned in the "Schedule of Quantities" or special specifications, the quality of materials, workmanship, dimensions etc., shall be as specified herein under.

The contractor without any extra cost for carrying out field-tests on materials shall provide all

58 Signature & Seal of Contractor

equipment and facilities.

Unless mentioned specifically, all materials used in the construction shall conform to the relevant Indian standards published by bureau of Indian standards.

The contractor whenever in doubt should get the materials approved by the architect, before use. A sample of approved material should be deposited with the architect.

Test certificates from the laboratory approved by the architect will have to be furnished, if so directed by him. The contractor will pay all costs for the same.

For special items to be used, the manufacturer's instruction of handling and installation shall be strictly adhered to. The contractor shall obtain, the guarantee certificate from the manufacturer and pass on the same to the owner.

Materials if supplied by the owner, shall be properly stored in the safe custody of the contractor. The same shall be carefully used and shall be properly preserved till the work is completed and handed over to the owner. Proper accounts of such materials will be maintained and will be presented for inspection and physical verification as and when requested by the owner.

Timber:

Timber generally is to be the best of its kind, well and properly seasoned, of mature growth, free from worm holes large loose or dead knots or other defects and sawn die square and will not supper warping, splitting or other defects through improper handling.

The wood is to be Steam beach weighting not less than 45 lbs per cubic foot with moisture content not exceeding 12% to 14%. The moisture content of timber shall be determined according to method described in paragraph 4 of is: 287 for "maximum permissible moisture content of timber used for different purpose in different zones".

In measuring cross-sectional dimensions of the frame pieces tolerance up-to 1.5 mm shall be allowed for each planned surface.

Good quality Steam beach wood:

Steam beach wood be of good quality and well seasoned. It shall have uniform color, reasonably straight grains and shall be free from large, loose dead knots, cracks, shakes, warp, twists, bends, borer, holes or defects of any kind. No individual hard and sound know shall be more than 1 cm. In diameter and aggregate area of all knots shall not exceed ½ % of the area of the piece. It shall be close gained and there shall not be less than 6 growth rings per 2.5 cm width.

Good quality Steam beach wood:

Steam beach wood shall be of good quality and well seasoned. It shall have uniform color reasonably straight grains and shall be free from large, loose, dead knots, cracks, shakes, warp, sound knot shall be more than 2.5 cm. In diameter and aggregated area of all knots shall not exceed 1% of the area of the piece. There shall not be less than 4 growth rings per 2.5 cm width.

Timber is to be cut to the required sizes and lengths as soon as practicable after the works are begun and stored under cover so that the air will circulate freely around it. Joinery is to be prepared, immediately after the placing of the contract, framed up (but not bonded) and stored until required for fixing in position, when it is to be bonded and wedged up. Any portions that warp or develop shakes or other defects are to be replaced before wedging up. The whole of the work is to be framed and finished in a proper and workman like manner, in accordance with

the detailed drawings, and fitted with all necessary motifs straps, belts screws etc. Running bounded joints are to be cross-tongued with teak onguese and where over 1-1/2" thick double cross tongued. Joiner's work generally is to be finished with fine class papered surfaces unless otherwise specified.

Templates boxes and moulds shall be accurately set out and rigidly constructed so as to remain accurate during the time they are in use.

Grounds are to be clean shown, free from large knots, splayed as required, plugged and fixed to walls etc. At 1'-6" centers.

Wood plugs are to be put cut on the twist. Patent wall plugs or plastic filling may be used in lieu of wood plugs with the approval of the architect.

All unexposed surfaces of timber e.g. fails ceilings, backings fillets backs of doors frames backs of doors frames, cupboard framing, grounds etc. Are to be treated with two coats of approved timber preservative like soigné, kirticite, term seal or castral or vacuum pressure impregnated with and approved water soluble timber preservative before fixing or bedding.

Timber shall be well seasoned and of the best quality Indian teak of specified species. Timber shall be considered as well seasoned, if its moisture content does not exceed the following limits.

- (1) timber for frames 14%
- (2) timber for planking, shutters etc 12%

The moisture content of timber shall be determined according to method described in paragraph 4 of is 287 for "maximum permissible moisture content of timber used for different purposes in different climatic zones".

In measuring cross-sectional dimensions of the frame pieces tolerance up-to 1.5mm shall be allowed for each planed surface.

Carpentry & Joinery:

The carpenter and joiner shall include the finishing of all labor, materials, equipment, and appliances required to complete the work including the installation of hardware as per the drawing. The timber shall be of the quality as described on the drawings or in the bills of quantities, shall be seasoned and uniform in texture, free from fungal growths, knots, waness, open shake borer holes, rot, decay, discoloration, soft or spongy spots, holes, rot, decay, discoloration, soft or spongy spots, hollow pockets, patch or box heart and all other defects.

Skilled workmen, using proper tools, shall carry out all the carpenter's work. All joints shall be securely nailed without splitting the wood. Wherever it is necessary the members shall be lapped of joining by g.i. stapes or extra wood blocks. All joints and nailing shall be done in neatness, and shall be approved by the architects. All assembly is exactly at right angles.

Finish woodwork and joinery including doors shall be surfaced with straight without any warp of bow and shall have smooth, well-planned faces at right angles to each other. The frame members shall be planned on the three sides exposed at right angles to each other.

All joinery work shall be securely mortised and tanned with synthetic resin conforming to I.S. 851-1957. Heads, posts, transoms, mullions of door and window frames shall be made out of single pieces of timber only. The heads and posts shall be thought - tanned into the mortises of not less than 1/2". Solid wood panels of not less than 5" and not more than 8" in width shall be

used and jointed together with tongue and groove joint.

All interior wood finish doors, cabinetwork shall be smoothly traded and sanded after erection, until all defects are entirely removed. Assembled door frame without sills shall be fitted with temporary stretchers. All exposed wood and plywood shall be straight-grained method grain and color and shall be approved by the architects. Interior wood finished doors cabinets and other fixed wooden equipments shall be properly installed, level plumb and true. But joints shall be avoided wherever possible; if unavoidable the joint shall be leveled. All exterior angles shall be mitered. Adjoining interior woodwork shall match and harmonies. All woodwork in contact with masonry shall be painted with bitumen paint or red oxide paint.

Joints:

All joints will be standard, mortised and tenon, dovetail, dowel, cross-halved, metered, tongued and grooved and rebated. Nailed or glued but joints, will not be permitted exceptional cases, ailed but joints will not be accepted. All joints shall be smeared with white lead.

Whenever solid wood is specified it shall be as per I.S.I. and of good quality. The type of wood shall be got approved before collecting the same on site. Fabrication of wooden members shall be started only after approval. It shall be free from large, loose, dead or cluster knots, flows, shakes, wraps, bends or any other defect. It shall be uniform in substance and of straight fibers as far as possible. It shall be free from rats, decay, harmful fungi and other dejects of nature which will affect the strength, durability of it usefulness for the purpose for which it is required. The color of wood shall be uniform as far as possible. The scantlings planks etc. Shall be seen in straight lines and planes in the direction of grain and have uniform thickness.

Plywood:

Plywood for general purpose shall confirm I.S. 303 MR grade & I.S. 710 B.W.P. / marine grade as specified. It shall be formed with 0.8 mm. Thicknesses commercial face veneers and 1.5 mm. Thicknesses. Intermediate veneers in two opposite grain direction shall be 1:1. The moisture content shall not be more than 12.5% by mass. It shall either be kit ply make or other equivalent approved make. Where B.W.P. grade is specified it should be boiling waterproof confirming to I.S. standards.

The plywood for general purpose shall conform to is I.S. 303 MR grade & I.S. 710 B.W.P. / marine grade as specified Cementing together thin boards or sheets of wood into panels makes plywood. There is always an odd number of layers 3,5,7,9 ply etc. The plies are placed so that grain of each layer is right angle to the grain in the adjacent layer.

According to is I.S. 303 MR grade & I.S. 710 B.W.P. / marine grade as specified the plywood for general purpose shall be of three grades namely I.S. 303 MR grade & I.S. 710 B.W.P. / marine grade as specified depending upon the adhesives used for bonding and veneers, and it will be further classified into six types namely aa, ab, ac, bb, bc and cc based on the quality of the two face, each face being of three kinds namely, a, b and c.

I.S. 303 MR grade & I.S. 710 B.W.P. / marine grade as specified formed with 0.8 mm. Thickness commercial face veneers and 1.5 mm. Thick intermediate veneers in to two opposite grain direction. The moisture content shall not be more than 12.5 % by mass. Where B.W.P. grade is specified it should be boiling waterproof conforming to Indian standards.

Laminates:

All the laminate to be used shall be of 1.0 mm (or 1.5 mm or 0.5 mm where specified) thickness in approved the color and shade as approved and specified by the architect. It shall be matt finish manufactured by recommended makes as per sample shown by the consultant unless otherwise specified. It shall satisfy all the I.S.I. standards for melamine coated laminated fiber board's before the use of such fiberboard laminated. The contractor shall have to take approval

62 Signature & Seal of Contractor

of the department of each sheet of the laminates

Fixtures & Fastenings:

The fixtures and fastening, that is, butt hinges, tend strap hinges, sliding door bolts, tower bolts, door latch, bath room latch, handles, door stoppers, casement window fasteners, casement stays and ventilators catch shall be made of the metal as specified in the item or its specifications.

They shall be of S.S., S.S. brush finish, iron, brass, aluminum, chromium plated iron, and chromium plated brass, copper oxidized iron, copper oxidized brass or anodized aluminum as specified.

The fixtures shall be heavy type. The fixtures and fastenings shall be smooth finished and shall be such as will ensure ease of operation.

The samples of fixtures and fastening shall be got approved as regards quality and shape before providing them in position. Brass and anodized aluminum fixtures and fastenings shall be bright finished.

Screws, nails, bolts will be of brass or other no corrosive metal. In hardware, they will match the finish of the hardware item. Nails, in a finished surface shall be neatly punched and the hole filled with wood filler matching the finish. Screws in a finished surface will be round head, raised head or sunk beneath the surfaces and the hole plugged with a wood plug with matching color and grain of the wood surface as directed.

S.S. fittings should be proper polish finished.

Screws, nails, bolts, will be of brass or non-corrosive metal. In hardware, they will match with the hardware items.

Nails, in a finished surface shall be neatly punched and the holes filled with wood filler matching the finish. Screws, in a finished surface will be round head, raised head or sunk beneath the surfaces and the hole plugged with a wood plug with matching color and grain of the wood surface, unless especially detailed

Hardware:

Hinges, locks, latches, door tracks etc. Shall be as specified and as far as possible, by the manufacturer specified. In any variation of this quality of the substitute shall be equal to or better than the original specified, and the samples shall be submitted to the architect for prior approval.

Hardware and metals:

The hardware throughout shall be of approved brand and supply well made and equal in every respect to the samples deposited with the architect. The contractor may be required to produce and provide samples many different sources before the architect is able to make the decision and he should allow in his rates for doing so.

Fittings generally shall have a brass finish or powder coated finish unless otherwise specified and should be suitable for their intended purposes.

Screws are to match the finish of the article to be fixed and to be rounded or flat headed or counter sunk as required.

Cover up and protect at the brass or powder coated surfaces with a thick grease or other

suitable material, renew as necessary and subsequently clean off and clear away on completion.

All steel, brass, bronze, aluminum and stainless steel articles shall be submitted to a reasonable test for strength. If so required by the architect at the contractors expenses.

Door closers:

The overhead door closer shall be of standard make as listed by the architect. The overhead door closer shall be of color as approved by the architect. Fixing of the overhead door closer shall be done by and experienced worker preferable from the principal supplier of the item.

After successful installation of the overhead door closer the same shall be checked for speed of door closing. The contractor shall make necessary adjusted operating mechanism as per manufacturer's guidelines to arrive at most suitable operating speed. The selected operating speed should remain constant on all repeated operations. If an overhead door closer is found to lose its adjusted operating speed often during warranty period then the shall have to be replaced with a new piece without charging any extra.

In case of a steel frame door the overhead door closer shall have to be mounted on a special plate supplied by the manufacturer. No extra payment shall be due for such mounting plate.

The rate shall include all materials, labor, required civil work etc. Complete and shall be paid per no. Of overhead door closers installed.

Paints:

Lime for lime wash, dry distemper, oil bound distemper, cement primer, oil paint, enamel paint, flat oil paint, plastic emulsion paint, anti-corrosive primer, red lead, water-proof cement paint shall be from an approved manufacturer and shall conform to the latest Indian standard for various paints. Ready mixed paints as received from the manufacturer without any admixture shall be used, except for addition of thinner, if recommended by the manufacturer. However, if ready mixed paint of specified shed or tint is not available then only ready mixed paint with approved strainer will be allowed. In such a case, the contractor shall ensure that the shade of the paint so allowed shall be uniform.

All the paints shall met with following general requirements:

Paint shall not show excessive setting in a freshly opened full can and shall easily be redispersed with a paddle to a smooth homogeneous state. The paint shall show no curdling, levering, cracking or color separation and shall be free from lumps and skins.

Paint as received shall brush easily; possess good leveling properties and show no running or sagging tendencies.

The paint shall not skin within 48 hours in a three quarters filled closed container.

The paint shall dry to a smooth uniform finish free from roughness, grit, unevenness and other imperfections.

General: wherever scaffolding is necessary, it shall be double scaffolding.

The surface shall be thoroughly brushed free from mortar droppings, and foreign matter. All steel work shall be cleaned of loose rust, mill scales, etc. So as to expose the original surface. All broken edges, cracks, loose-plaster and wavy surface shall be brought up either by patch plasterwork or by plaster of Paris.

All materials viz. Dry distemper, oil bound distemper, oil paint, flat oil paint, synthetic enamel paint, plastic emulsion paint, cement primer, red lead and other primers and metallic paints shall conform to respective i.s. specifications and shall be obtained from approved manufacturers.

Painting - Flat / Plastic emulsion etc.:

Ready mixed flat oil paint, plastic emulsion paint, ready mixed synthetic enamel paint, aluminum paint, etc. Shall be brought in original containers and in sealed tins, if for any reason thinner is necessary, the brand and quality of thinner recommended by the manufacturer or as instructed by the architect shall be used.

The surface shall be prepared as specified above and a coat of approved primer shall be applied. After 24 hours drying, approved or specified quality paint shall be applied evenly and smoothly. Filler putty coating may be given to give a smooth finish. Each coat shall be allowed to dry out thoroughly and then lightly rubbed down with sand paper and cleaned of dust before the next coat is applied. Number of coats shall be as specified in the item and if the finish of the surface is not uniform, additional coats as required shall be applied to get good and uniform finish at no extra cost. After completion no hair marks from the brush or clogging of paint puddles in the corners of panels, angles or moldings etc. Shall be cleaned of stains.

Pigmented priming coat (emulsion thinned with water) followed by three or more finishing coats of plastic emulsion paint. Pasted filler to be applied after every coat exempting the final finishing coat and sanded. When the final coat is applied, if directed the surface shall be rolled with a roller or if directed, it shall be stippled with a stippling brush.

Enamel paints

Oil paints shall be of first quality and of the specified color and shade, and as approved. The ready mixed paints shall be only used. However, if ready mixed paint of specified shade or tint is not available while ready mixed paint with approved strainer will be allowed. In such a case, the contractor shall ensure that the shade of the paint so allowed shall be uniform.

All the paints shall meet with the following general requirements:

Paint shall not showed excessive setting in a freshly opened full can and shall easily be redisbursed with a paddle to a smooth homogeneous stage. The paint shall show no curdling levering, caking or color separation and shall be free from lumps and skins.

Paint as revived shall brush easily; possess good leveling properties and show no running or sagging tendencies.

The paint shall not skin within 48 hours in a three quarters filled closed container.

The paint shall dry to a smooth uniform finish free from roughness, grit, unevenness and other imperfections.

Ready mixed paint shall be used exactly as received from the manufacturers and generally according to their instructions and without any admixtures what so ever.

French polish:

The French polish of required tint and shape shall be prepared with the below mentioned ingredients and other necessary material:

- (i) denatured spirit of approved quality
- (ii) chandras
- (iii) shellac
- (iv) pigment

The French polish so prepared shall conform to is 348.

French polishing:

French spirit polish shall be an approved make conforming to i.s.: 348. If it has to be prepared on site, dissolving 0.7 kg shall make the polish. Of best shellac in 4.5 liters of mentholated spirit without heating. To obtain required shade pigment may be added and mixed.

Surface shall be cleaned. All unevenness shall be rubbed down smooth with sand paper and well dusted. Knots, if visible, shall be covered with a preparation of red lead and glue. Resinous or loose knots and gaps shall be filled with seasoned timber pieces and made level with rest of the surface. Holes and indentations on surface shall be filled with putty made of whiting and linseed oil. Surface shall be given a coat of filler made of 2.25 kg. Of whiting in 1.5 liter of mentholated spirit. When it dries, surface shall again be rubbed down perfectly smooth with sand paper and wiped clean.

Piece of clean fine cotton cloth and cotton wool made into shape of pad shall be used to apply polish. The pad shall be moistened with polish and rubbed hard on the surface applying the polish sparingly but uniformly and completely over the entire surface. It shall be allowed to dry and another coat applied in the same way. To give CIVIL coat the pad shall be covered with a fresh piece or clean fine cotton cloth, slightly damped with mentholated spirit and rubbed lightly and quickly with a circular motion, till the finished surface attains uniform texture and high glass.

Wax polishing:

Wax polish shall either be prepared on site or obtained ready made from market. Polish made on the state shall be prepared from a mixture of purr bees wax, linseed oil, turpentine oil and varnish in the ration or 2:1 ½:1: ½ by weight. The bee's wax and the boiled linseed oil shall be heated over a slow fire. When the wax is completely dissolved the mixture shall be cooled till it is just warm, and turpentine oil and varnish added to it in the required proportions and the entire mixture is well stirred.

Surface shall be prepared as described under "French polishing" except that the final rubbing shall be done with sand paper, which has been slightly moistened with linseed oil.

Mixture or polish shall be applied evenly, with a clean cloth pad in such a way that no blank patches are left, and rubbed continuously for half an hour. When the surface is quite dry a second coat shall be applied in the same manner and rubbed continuously for an hour or until the surface is dry. Final coat shall then be applied and rubbed for two hours or more if necessary, until the surface has assumed a uniform glass and is quite dry showing no sign of stickiness when touched. Glass rubbing must be continuous and with uniform pressure and frequent change is direction.

PU Coating – PU coating on wooden surfaces shall be as per Indian Standard code of practices.

Glass:

All glass shall be of best quality, free from flaws, specks, bubbles, veins, smokes, air holes blisters and other defects. The thickness and kind of glass to be used shall be as mentioned in the item or as shown in detailed drawing. The thickness of glass panel shall be uniform. All glass shall be of approved make by the architect and conforming to is 3548.

All glass shall be float glass of the best quality, free from specks, bubbles, smokes, veins, air holes, blisters and other defects. The kind of glass to be used shall be as mentioned in the item or specification or in the special provisions or as shown in detailed drawings thickness of glass panel shall be uniform. All glass to be approved manufacture complying with is: 3548-1966 or

as per approved quality and sample.

The compound for glazing to metal is to be special non-hardening compound manufacture for the purpose and of 9 brands and quality approved the interior designer.

In cutting glass, proper allowance shall be made for expansion. Each square of glazing to be in one whole sheet and after cutting the edges to be properly filled.

On completion, clean all glass inside and out, replace all cracked scratched or broken panes and leave in good condition to the satisfaction of the architect.

The contractor shall furnish all labor, materials, and equipments required for the installation of glass and glazing items.

The glass shall be of the type, quality and substance specificity in the bills of quantities.

In case of the glass being supplied by the owners, the contractor shall take the delivery of the glass at site and shall be responsible for proper handling and stacking. We shall insure glass against theft, fire, etc.

The contractor shall replace at his own expense all broken, damaged or disfigured glass caused in the execution of the work of faulty installation, before the virtual completion of the work. Patterned or translucent glass shall be 4 mm. In thickness and shall be approved by the architects. Sheet glass shall be in 5 mm. In thickness. Wired glass shall be 6 mm. In thickness.

The putty used for glazing metal door, window or ventilator shall conform to I.S. 420:1953.

Before installation of the glass, the contractor shall ensure against the following:

All glazing rebates shall be square, putty, true in plane, clear, dry and free of dust. The frames shall be adjusted before glazing. The weight of the glass in side hung casement causes it to drop slightly on its hinges. Before glazing it shall be set in slightly high position in its frame. Glass edges shall be clean and cut to the exact size, chipped or damaged edges shall be rejected. Sashes shall be glazing in the closed position and shall not be open till the putty is set. The glass shall be set in teak wood beading or metal glazing chips and so installed to achieve water lightness.

The platter glass shall be bedded on strips of leather or felt turned over the two sides of the glass to form packing between the glass and the metal coating. The ground glass shall be getting with smooth surface outside.

Glazing large panes of glass, or when heavy wind pressure is experienced, glazing bead may be used instead of front putty. In this case putty shall be applied to the face of the bead, which is in contact with glass. Putty would also be necessary, at the back.

Beads shall be of timber, rustproof steel or aluminum and shall have mitered corners. The position and size of the bead may depend on the thickness of glass used. The beads shall be fixed with screws 0" apart.

On completion of the job, all glass shall be thoroughly cleaned. All paint or other marks to be removed.

SPECIFICATION FOR WORKMANSHIP

Painting And Polishing: Various Readymade Paints:

The surface to be painted shall be cleaned and all cracks, holes and surface defects shall be repaired with plaster of Paris. All irregularities shall be sand papered and wiped clean. The surface so prepared must be dry and free from dust.

The priming coat shall be applied over in the manner recommended by the manufacture in case of special paint. When no priming coat is specified by the manufacturer, putty composed of powered whitening chalk mixed with double polished linseed oil of required workable consistency shall be applied to prepare a good, hard background in case of undecorated surfaces. The surface shall be then rubbed down again with a fine grade sand paper and made smooth.

The paint shall be of 1st quality and of specified color and shade and as approved.

Ready mixed paint as received from the manufacturer without any admixture shall be used, except for addition of thinner, if recommended by the manufacturer. However, if ready mixed paint of specified shade or tint is not available while ready mixed paint with approved strainer will be allowed. In such a case, the contractor shall ensure that the shade of the paint so allowed shall be uniform.

Polishing To Wood Work:

Woodwork to be polished shall be finished smooth with plane. It shall then be rubbed smooth with medium and fine sand papers. In no case sand paper shall be rubbed across the grains. All holes, cracks, open joints and small defects if all allowed to remain by the architect shall be stopped with putty made from pure whiting mixed to the proper consistency with linseed oil.

Polish shall be applied in very thin coats with special fine haired varnishing brushes. Before applying first coat after stopping, the wood surface shall be rubbed down lightly with a fine sand paper taking care to rub along the grains and to leave the color even. The number of coats shall be as specified in the item.

Measurement:

No separate measurement and payment shall be made for such finishing work. The cost of such finishing shall be included in the rate of related item of woodwork. But if the item is to be carried out independent item of measurement shall be as per is 1270.

Melamine polishing to wood work:

All unevenness shall be rubbed down to smooth with sand paper and surface shall be cleaned of dust.

The wood to be polished should be first painted with filler composed of a mixture of whiting and mentholated spirit to obtain a good glass surface. The surface shall be again rubbed down for making perfectly smooth with sand paper.

The number of coats of melamine polish shall be as specified in the item. On the woodwork a pad of woolen cloth covered by fine cloth shall apply a thin coat of melamine polish. The pad shall be moistened with polish and rubbed on a surface in a series of overlaying circles, applying the polish uniformly over the entire area to give even surface. A trace of linseed oil on the face of pad facilitates this operation. The surface shall be allowed to dry and the remaining

coats shall be applied in the same manner to finish off. The pad shall be covered with a fresh piece of clean fine cloth, slightly dampened with mentholated spirit and rubbed lightly and quickly with circular motion.

The finished surface shall have uniform texture and high gloss. The melamine polish shall be applied with spray gun and even coating shall be applied to get the very good quality of finishes.

Measurement:

No separate measurement and payment shall be made for such finishing work. The cost of such finishing shall be included in the rate of related item of woodwork. But if the item is to be carried out independent item of measurement shall be as per IS 1270.

SECTION – A: MATERIALS

- 1) Material shall be of best approved quality obtaining and they shall comply with the respective Indian Standard Specification.
- 2) Samples of all materials shall be got approved before placing order and the approved sample shall be deposited with the Architect.
- 3) In case of non-availability of materials in metric sizes the nearest size in FPS units shall be provided with prior approval of the Architects for which neither extra will be paid nor shall any rebates be recovered.
- 4) If directed, materials shall be tested in any approved Testing Laboratory and the test certificates in original shall be testing including charges for repeated tests, if ordered, shall be borne by the Contractor.
- 5) It shall be obligatory for the Contractor to furnish certificate, if deemed by the Architects, from manufacturer or the material supplier that the work has been carried out by using their material and as per their recommendations.
- 6) All materials supplied by the Employer / any other Specialist Firms shall be properly stored and the Contractor shall be responsible for its safe custody until they are required on the works and till the completion of the work.
- 7) Unless otherwise shown on the Drawings or mentioned in the “Schedule of Quantities” or special specification, the quality of materials, workmanship, dimensions, etc., shall be as specified as hereunder.
- 8) All equipment and facilities for carrying out field tests on materials shall be provided by the Contractor without any extra cost.

a) Cement:

Cement shall comply in every respect with the requirements of the latest publications of IS: 269 and unless otherwise specified ordinary Portland Cement shall be used. The weight of ordinary Portland Cement shall be taken as 1440 kg. per cu.m. (90 lbs. per c.ft.). Cement shall be measured by weight and in whole bags, and each undisturbed and sealed 50 kg. bag being considered equivalent to 35 liters (1.2 c.ft.) in volume care should be taken to see that each bag contains full quantity of cement. When part bag is required cement shall be taken by weight or measured in measuring boxes. No other make of cement but that approved by the Architects will be allowed on works and the source of supply will not be changed without approval of Architect

in writing. Test certificates to show that cement is fully complying the specifications shall be submitted to the Architects and notwithstanding this, the Architect may at his discretion, order that the cement brought on site and which he may consider damaged or of doubtful quality for any reason whatsoever, shall be re-tested in an approved testing laboratory and fresh certificates of its soundness shall be produced. Cement ordered for re-testing shall not be used for any work pending results of re-test. Cement shall be stored in weather-proof shed with raised wooden plank flooring to prevent deterioration by dampness or intrusion of foreign matter. It shall be stored in such a way as to allow the removal and use of cement in chronological order of receipt i.e., first received being used first used. Cement deteriorated and or clotted shall not be used on the work but shall be removed at once from the site. However, allowing use of warehouse set cement shall be determined by the Architects.

b) Lime:

Lime shall comply in every respect with the requirements of IS: 712 and shall be made from approved lime stone or kankar and properly burnt. It shall be free from excess of unburnt kankars or lime stone ashes or other extraneous materials and shall be stored in weather-proof sheds. Lime which has damaged by rain, moisture, or air slacking shall not be used but shall be removed from the site of work forthwith. Lime shall be slacked with fresh water and screened through appropriate screens and stored and used within 14 days provided it is protected from drying out. Field tests according to IS: 1624 shall be carried out from time to time to determine the quality of lime.

c) River Sand:

River sand shall confirm to IS: 383 and relevant portion of IS: 515. It shall pass through pass through a I.S. sieve 4.75 mm. (3/16 B.S.) test sieve, leaving a residue not more than 5%. It shall be from natural source i.e. only river or crushed stone screenings, if allowed, chemically clean, sharp, hard durable, well graded and free from dust, pebbles, clay, shale, salt, organic matter, loam, mica or other deleterious matter. The sum percentages of all deleterious substances to acceptable limits. River sand shall not contain any trace of salt and it shall be tested and river sand containing any trace of salt shall be rejected. The fine aggregate i.e. river sand for concrete shall be graded within limits as specified in IS: 383 and the fineness Modules may range between 2.60 to 3.20. The fine aggregate shall be stacked carefully on a clean hard dry surface so that it will not get mixed up with deleterious foreign materials. If such a surface is not available a platform of planks or corrugated iron sheets or brick floor or a thin layer of lean concrete shall be prepared.

d) Fine & Coarse Aggregate:

Shall consist of crushed or broken stone 95% of which shall be retained on 4.75 mm.

68 Signature & Seal of Contractor

IS tests sieve. It shall be obtained on crushing Granite, Quartzite, Trap, Basalt, or similar approved stones from approved quarry and shall confirm to IS:383 and IS 515. Fine & Coarse aggregate shall be chemically inert when mixed with cement and shall be cubical in shape and be free soft, friable, thin, porous, laminated or flaky pieces. It shall be free from dust and any other foreign matter. Gravel / Shingle of desired grading may be permitted as a substitute in part or full in plain cement concrete if the Architect is otherwise satisfied about the quality of aggregate. For all the R.C.C. works the size of coarse aggregate shall be 20 to 25 mm. and fine aggregate shall be 10 to 15 mm.

e) Reinforcement:

Reinforcement shall be of mild steel tested quality confirming to I.S.: 432-1966 and any other I.S. applicable or deformed bar confirming to IS:1786 and Is:1139 or hard drawn Fe 415 (Tor Steel) steel wire fabric confirming to IS:1566;1967. All finished bars shall be free from cracks, surface flaws, laminations, jagged and imperfect edges.

f) Bricks :

Bricks shall generally comply with IS:1077 except in size which shall be classified as 1st and 2nd class. 1st class bricks shall be the best quality locally available table moulded, well burnt but not over burnt, have plain rectangular faces with parallel sides and sharp right-angled edges, have a fine compact and uniform texture. The bricks shall be free from cracks, chips, flaws, stones or subsequent to soaking in water. It shall emit a clear ringing sound on being struck and shall not absorb water more than 20% by weight. Common building bricks shall have a compressive strength of 35 kg. / sqm unless otherwise specified for first class bricks.

g) Neeru:

Shall be made of Class "C" Lime (i.e. pre-fat lime) as mentioned in IS: 712. It shall be slaked with fresh water then sifted and reduced to a thick paste by grinding in a mill. Neeru thus prepared shall be kept moist until used and no more than that can be consumed in 15 days shall be prepared at time.

h) Surkhi :

Shall be made by grinding well burnt bricks, brick bats, burnt clay balls, etc., the brick etc., to be used shall be prepared from selected clay. The quality shall confirm to IS:1344. Bricks bats, etc., shall be ground in mechanical disintegrator to a fine powder passing through IS Sieve No. 9 (2.36 mm.) with a residue not exceeding 10% by weight. Surkhi for lime surkhi plaster shall be ground to fine powder in a mortar mill to pass through IS Sieve 150 micron (No. 100) Surkhi shall be stored in a weather-proof shed on a brick paved platform.

l) Water :

Water for mixing cement / lime / surkhi mortar or concrete shall not be salty or brackish and shall be clean, reasonably clear and free from objectionable quantities of silt and traces of oil, acid and injurious alkali, salts, organic matter and other deleterious materials which will either weaken the mortar or concrete or cause effluence or attack the steel in reinforced cement concrete. Water shall be obtained from sources approved by the Architect. Potable water is generally considered satisfactory for mixing and curing concrete, mortar masonry, etc., where water other than main source is used this shall be tested in an approved testing laboratory to establish its suitability. All charges connected therewith shall be borne by the Contractor.

j) Timber :

Timber shall be well seasoned and of the best quality Indian Teak of specified species viz., Dandeli, Balارشah, Melabar, C.P. Timber shall be considered as well seasoned, if its moisture content does not exceed the following limits. a) Timber for frames 14% b) Timber for planking, shutters, etc. 12% The moisture content of timber shall be determined according to method described in paragraphs 4 of IS:287 for Maximum permissible moisture content of timber used for different purpose in different climatic zones. In measuring cross-sectional dimensions of the frame pieces tolerance up to 1.5 mm. shall be allowed for each planed surface.

k) Superior quality Indian Teak Wood :

Superior quality Indian Teakwood means Dandeli, Balارشah, and Malabar Teak. It shall be of good quality and well-seasoned. It shall have uniform colour, reasonably straight grains, and shall be free from large. Loose, dead knots, cracks, shakes, warp, twists, bends, borer holes, sap-wood or defects of any kind. No individual hard and should knot shall be more than 1 cm. in diameter and aggregate areas of all knots shall not exceed ½% of area of the piece. There shall not be less than 6 growth rings per 2.5 cm. width.

l) 1 st Class Indian Teakwood :

1 st Class Indian Teakwood means C.P. and Bulsar teak of good quality and wellseasoned. It shall have uniform colour, reasonably straight grains and shall be free from large. Loose dead knots, cracks, shakes, warp, twists, bends, sap-wood or defects of any kind. No individual hard and should knot shall be more than 2.5 cm. in diameter and aggregate areas of all the knots exceed 1% areas of the piece. There shall not be less than 5 growth tings per 2.5 cm. width.

m) 2 nd Class Indian Teakwood :

Shall be similar to first class Indian teak wood except that knot up to 4 cm. diameter and aggregate area of all knots up to 1 ½% of the area of the piece shall be allowed. There shall not be sapwood up to 15% is allowed.

n) Flush Doors :

All flush doors shall be solid core exterior grade unless otherwise specified and it shall generally confirm to IS:2202 and shall be fabricated as described under specification.

o) Steel Windows and Doors :

Steel windows and doors shall be fabricated of steel sections conforming to IS:226. They shall conform to IS 1038. Unless otherwise specified the details of construction etc., shall be as described under specification.

p) Floor Tiles :

Designer pre-cast concrete tiles and interlocking paver block, plain cement tiles, chequered tiles, mosaic tiles terrazzo tile shall conform to IS:1237. For neutral shade tiles grey cement shall be used. Tiles shall be compacted by mechanical vibration and hydraulically pressed. It shall be of choice shade and shall have desired pattern of chip distribution. The sizes of chips to cement in terrazzo or mosaic floor shall be as specified in IS:1237. The size and thickness of tiles shall be as approved by the Architect.

q) Ceramic / Vitrified Tiles :

White or coloured glazed tiles shall comply with IS:777 or relevant or latest I.S. code. It shall be from an approved manufacturer and shall be flat and true to shape. They shall be free cracks, crazing, spots, chipped edges and corners. The glazing and colour shall be uniform shade and unless otherwise specified the tiles shall be 6 mm. thick.

r) Marbles :

Marble slabs for flooring, dado veneering etc., shall be of kind specified in the item such as white or pink, Makrana, Chittor black, Bhanslana black, Jaisalmer yellow, Baroda green, Patiala (Pepsu) grey, etc., Marble from which slabs are made shall be selected quality, hard, sound dense and homogenous in texture and free from cracks, weathering, decay and flaws. Before starting the work, the contractor shall get the sample of Marble slabs approved by the Architect. The slabs shall be machine cut and machine polished.

s) Kotah / Shahbad / Cudappa / Granite :

Shall be of selected quality, hard, sound, dense, and of homogenous texture, free from cracks decay, weathering and flaws. Stone slabs shall be of uniform colour as approved by the Architect. They shall be machine cut and machine polished where specified and shall confirm to the required size. Thickness shall be specified in the respective items.

t) Glazing :

Glass used for glazing shall be float glass of best quality, free from flaws, specks bubbles and shall be 2.9 mm. thick up to 0.60 x 0.60 mm. size and for larger size it shall be 4 mm. thick unless otherwise specified in the Schedule of Quantities. The following type of glasses shall be used:- 1) For Office Building Clear glass or as specified in the Schedule of Quantities. 2) Office (toilets) Clear or frosted 3) Partitions Frosted

u) Asbestos Roofing & rain Water Pipes :

All Asbestos pipes and fittings shall comply with IS:459 and shall be free from cracks, chipped edges of corners and other damages.

v) MPI. Sheets :

MPI. Sheets shall be of a gauge specified in the description of the item and shall conform to the IS:277. The sheets shall be free from cracks, spilt edges, twists, surface flaws, etc. They shall be clean bright and smooth. Galvanising shall be uninjured and the perfect condition. The sheet shall show no sign of rust or white powdery deposits on the surface. The corrugations shall be uniform in depth and pitch and parallel.

w) Paints :

Lime for lime wash, dry distemper, oil bound distemper cement primer, oil paint, enamel paint, flat oil paint, plastic emulsion paint, anti-corrosive primer, red lead, water-proof cement paint and exterior grade Acrylic Emulsion paint, cement paint, sand-tex matt shall be from an approved manufacturer and shall conform to the latest Indian Standard for various paints. Ready mixed pains as received from the manufacturer without any admixture shall be used, except for addition of thinner, if recommended by the manufacturer.

x) Mortar :

Lime Surkhi Mortar :

Lime and surkhi shall confirm to the specifications. It shall be composed of approved lime and surkhi in proportion of 1 lime to 2 surkhi mixed thoroughly. The ingredients shall be accurately gauged by measure and shall be well and evenly mixed together on a platform and water added to make it homogenous. When large quantities are required the mortar shall be mixed in a mechanical grinder.

Cement Mortar :

Cement mortar shall be of proportions specified for each type of work in the schedule. It shall be composed of Portland Cement and sand. The ingredients shall be accurately gauged by measure and shall well and evenly mixed together in a mechanical pan mixer, care being taken not to add more water than is required. No mortar that has begun to set shall be used. River sand shall be used unless otherwise specified. If hand mixing is allowed, then it shall be done on pucca water-proof platform. The gauged materials shall

be put on the platform and mixed dry. Water will then be added and the whole mixed again until it is homogenous and of uniform colour. Not more than one bag of cement shall be mixed at one time and which can be consumed within half an hour of its mixing.

Composite Lime, Cement, Sand Mortar :

The mortar shall be of proportions specified for each type of work in the schedule of quantities. It shall comprise of Portland cement, lime and sand. Lime shall be measured in gauge boxes similar to one used for measuring cement and sand to the proportion specified and sufficient water then added to it to form a thick slurry thus obtained shall then be added to dry cement and sand mixture and thoroughly mixed to make a workable homogenous mortar of uniform colour by adding more water if necessary. Mechanical mixers shall generally be used for mixing such mortars. If hand mixing is allowed it shall be done on pucca platform.

Note : In connections with the I.S. Code numbers indicated under Section, Specification, Section A – General Refer to the following I.S. Code numbers and the year and or otherwise latest modified I.S. Code Number.

- 1) Cement : I.S. 269 – 1976
- 2) Lime : I.S. 712 – 1964 I.S. 1624 – 1960
- 3) Fine – Aggregate : I.S. 383 – 1970
- 4) Coarse – Aggregate : I.S. 515 – 1970
- 5) Reinforcement : I.S. 432 – 1966 Fe 415 I.S. 1786 – 1966 (Tor Steel) I.S. 1139 – 1966
- 6) Bricks : I.S. 1077 – 1970
- 7) Neeru : I.S. 712 – 1964
- 8) Surkhi : I.S. 1344 – 1968
- 9) Timber : I.S. 287 – 1960
- 10) Flush Doors : I.S. 2202 – 1966
- 11) Floor Tiles : I.S. 1237 – 1980
- 12) Ceramic / Vitrified Tiles : I.S. 777 – 1970
- 13) Asbestos Roofing and Rainwater pipes : I.S. 459 – 1962
- 14) R.C.C. design mix M-25 : I.S. 456 – 2000

SPECIFICATIONS (MAKES/MODELS)

LIST OF APPROVED BRAND AND / OR MANUFACTURER FOR INTERIOR FURNISHING WORK

SN	Particulars and Specifications	Approved Make/ model
1	Gypsum Board	Gyproc (saint gobain)/ USG BORAL
	Framing with complete system	Gyp steel ultra (saint gobain) /USG BORAL
2	Locks	
	Auto latch Lock	Godrej/P-ALL1-22 (Ebco)/EG
	Multipurpose group Lock	E-MPL1-22 / E-MPL1C-22 (Ebco)/EG/Godrej
	Night latch	8812 (Godrej)/ Doorset-NL 180 s/s / Europa 8010 NS of SS brush Finished
	Cylindrical lock (SS matt finish)	3792-with key and 3786-keyless (Godrej) / C120SS (Europa)
	Mortise dead lock (two way)	8815(Godrej)/ Door set -ML 102 S/ Dorma Make
	Mortise lock with door handle	Matiz 8083(Godrej) / Door set- HL 170 S/S / Dorma Make
3	Drawer channels	
	Telescopic channels (zink plated)	STDS35(i)35/ STDS45(i)35/ STDS50(i)35/ STDS60(i)35 (Ebco)/ EFG/Everite/Hettich
	Bottom channels (powder coated)	BMDS 35/ BMDS 37/ BMDS 55/ BMDS 60 (Ebco)
4	General hardware	SS matt finish
	Door stopper	i) Black/ivory/brown/silver color Powder coated DS1 (Ebco) ii) Spring type black/brown/ivory color powder coated (ECGL's sterling)
	Square/'D' bracket	50x12 mm (Oswal), Riddhi, Swift
	Hinges	i) 3"/4"/5"/6" 1.8mm th. SS matt finish (Suzu) ii) 75x12x19 1.2 mm th. SS matt finish for storage (Suzu) iii) Auto close hinges – slip on hinge- euro / click on hinge-I (Ebco) for storage
	Handles 'D' or 'C' type	1) 3"/4"/6"10mm dia SS 202 matt finish (Anjali)
	Tower bolt	3"/4"/6"/8" brass extruded SS matt finish (Oswal)
5	Floor spring	
	60 kg	7477 (Godrej) / M-74 (Hardwyn)/Dorma /Everite
	80 kg	8293 (Godrej) / M-74 (Hardwyn)/Dorma/Everite
	100 /120 kg	8294 (Godrej) / M-76 (Hardwyn)/Dorma/Everite

Signature & Seal of Contractor

6	Door closer	
	60 kg	Double speed 8292-silver, 7345- golden (Godrej) / scorpio (Hardwyn)/Dorma/Ebco/Ozone
	Fire rated 60 kg	1938 (Godrej) / Triton (Hardwyn)
7	Patch fittings for door and fixed glass partition (top/bottom patch, pivot, patch	Godrej / XL C series (Dorma) / OPF series (Ozone)
8	Particle boards	Novapan / Deco board
9	Computer accessories	
	Keyboard tray with mouse tray	KTE-1-45M (Ebco) / Hettich / Innofit / Featherlite
	CPU hanger/ shelf	Side mounted IS CPU HL SM (Innofitt) /CPUSM(Ebco) , 4/2-SMCS (Zipco)
	cable manager (60mm)	i) metal - CO60ZN1(Ebco) ii) PVC - CO 60 (Ebco) black/ivory/grey color
10	Foam	Sleepwell / Feather foam
11	Glass film	3M INDIA /AVERY DENNISON
12	Wood For Partition and Paneling Frame	Marandi wood or Equivalent
13	Wooden for Visible surface (ie. Beading, jambs, etc.)	Steam Beach or Equivalent
A	INTERIOR WORK	
1	Vitrified floor tiles(600mm x 600mm)	Johnson / Nitco / Kajaria / simpolo / Varmora
2	Adhesive	Favicol SH / Blue coat / Royel bond / Mevicol
	Sealant	Pidilite / Roaper
3	Paint on Wall & Ceiling	Asian Paint / Nerolac
4	Paint on Wood: Polyurethane systems (PU)	Sirca Paint / Asian paint
5	(Alternate core / Ply wood IS 303 BWR)/ (Marine / water proof ply IS 710 BWP) / Block Board IS 1659 / Flush Door IS 2202	Green / Century / Kit / Duro / Durian
6	Laminate IS 2046	Green / Formica / Sunmica / Marino / Century/ Greenlam / Archid / Aerolam.
7	MDF Exterior Grade ISI Mark	Nuwood / Action tesla / Dura turff / Century / Green

Signature & Seal of Contractor

8	Gypsum Board	Saint Gobain (India Gypsum)
9	Timber for lipping, moulding & when furniture is to be finished in polish	Superior quality seasoned Ghana teak.
10	Timber for all other type of furniture work	First class seasoned C.P. Teak.
11	Decorative laminate (1.0mm)	Marino / Green / Sunmica / Formica
12	Exterior Grade Compact Laminate (5mm,6mm)	Clads (Greenlam) / Staylam
13	Veneer	Green ply nature max / Century / Lignin
14	Hardware	
	a) Latches	Ebco / Hafele / Hettich
	b) Locks	Ebco / Hafele / Hettich / Godrej
	c) Screw	Nettle fold / GWK / Hafele
	d) Floor Spring	Doorset / Dorma / Ozone / Godrej
	e) Patch Fitting	Dorma / Haffle / Ozone
	f) Handles	Doorset / Ozone / Godrej
	g) Drawer slides telescopic	Ebco / Hafele / Hettich
	h) Key board tray	Ebco/ Hettich / Innofit
	i) CPU trolley	Ebco/ Hettich / Innofit
	j) Door Closer	Ozone / Dorma / Hafele / Godrej
	k) Cable Manger	Ebco / Easy
	l) Glass Bracket	Flora / Riddhi
	m) Magnet	Suprime / Bentex / Honda
	n) Tower Bolt	Rolex / Flora / Riddhi
	o) Hinge	Suzu matt / Gary premium
	p) Nails	Mehta / chakra / Sun
	q) L & key	Riddhi / Prince
15	Glazing, Lacquered glass	Tata / Modi guard / Saint gobain/ Asai, HNG.
16	Vinyl & Glass film	3M India / Avery Dennison
17	Roller Blinds	Vista wall fashion / Mac
18	Fabric	Masper / D Décor
19	Calcium silicate board	Hilux (Ramco)/ Saint Gobain / Usqboral /
20	Mineral fiber ceiling tiles tabulated profile	Armstrong / USG / Usqboral / AMF
21	Fire proof pvc sheet	Vardhman wonder boards / Hilux
22	Corian (Solid Surfaces)	DUPONT/ LG / Samsung
23	Solid hardwood floor	Vista / Armstrong / Squarfoot

Signature & Seal of Contractor

24	ACP	Aludecore / Armstrong / Urobond / Timex
25	Aluminum skirting	Ozone
26	Aluminum Section	Jindal / Hindustan / Hindalco
27	Modular items like chairs, storage units, drawer units	Featherlite/ godrej / wipro
28	Wall Putty	Birla white / J.K. white
29	Texture paint	Asian / Nerolac
30	Sanitary Fixture	Hindware / Jaquare / Grohe / Kohler
31	Sanitary Fittings	Hindware / Jaquare / Grohe / Kohler
32	Wall paper	Green / Asian

Note:

- [a] Where other Material are proposed to be used these should be got approved from the Architect/Bank's Engineer before execution of particular item. In case of Non- Availability of any material of specified make, the Alternative equivalent make should be used only after it is Approved in writing by the Employer or the Architect. The Material shall be used in preferential Order only.
- [b] Before starting of work, contractor must get all samples/make approved from Architect/Bank's authorities before using at site
- [c] Consultants/Bank's authorities reserve the right to add or delete name of any manufacturers and when required.
- [d] Consultants/Bank's authorities reserve rights to select any of the specified brands mentioned above.
- [e] If any material is found to be not up to the mark, the contractor will have to produce original bills/certificate from the manufacturer or his authorized Distributor for authenticity and genuineness of the material for consideration and as per make approved by the STATE BANK OF INDIA. The same will not be considered for payment.



Signature & Seal of Contractor

LIST OF APPROVED MAKE FOR CIVIL WORKS

1) Ordinary Portland Cement	As per latest approved list from R & B Dept.
2) White Cement	Birla, J.K.
3) TMT "Fe – 415/ 500 D" Ribbed bars	Tata, RINL. (VIZAG). SAIL
4) Structural Rolled Steel sections-beams,	Tata, SAIL, RINL. tee, flats, angles, bars (round, square, hexagonal)
5) Structural Hollow steel sections	(Square & Tata, Asian, Jindal, Surya, Appolo. Rectangular)
6) Structural tubular sections	Tata, Asian, Jindal, Surya, Appolo.
7) Coarse Aggregates (machine cut)	6mm to 40mm sizes Approved quarry from Sevalia. (Hardblack trap stone)
8) Stone Rubbles & Gravels	Approved quarry from Sevalia. (Hard black trap stone)
9) Shuttering plywood	Anchor, Green, Archid, Silicon, Century
10) Compact sheet	Alfiaca, Sundek, Vir, Bloom, Formica, merino.
11) Dead Locks/ Mortise locks/ Dorset, Yale. Narrow stile dead locks/ Tubular locks	Kich, Dorma,
12) Reflective Glass	Saint Gobain, PPG, Asahi, Emirates, Pilkington.
13) Paver block	Vyara, Super eq..
14) MS Rolling shutter	Sona, Sagar, Suryoday, Gandhi,.
15) Precast terrazo tiles & skirting (Mosaic)	Royal(rajkot), Alcock, Vyara, Nitco,.
16) Glazed tiles	Johnson, Kajaria, Nitco, simpolo, Varmora
17) Ceramic tiles	Johnson, Nitco, Kajaria, Varmora, Simpolo
18) Vitrified tiles	Kajaria, Johnson, Simpolo, Nitco, Varmora
19) Non-metallic floor hardener	Ironite
20) Glass mosaic	Bisazza,
Palladio	
21) Construction chemicals	
Plasticisers, Bonding agents, SBRmicro concrete	BASF,
Fosroc Water proofing chemicals	
Chemical Water proofing & Integral water proofing compound	
Crystalline water proofing	Cico or Pidilite Penetron or Kryton
22) Silicon sealant/ Silicon paint	Wacker, Dowcorning, GE, Soudal,
Bostik Polysulphide sealant	
P.U sealant/	Pidilite, Chawksey, Sika (Exterior grade - UV resistant)
23) Pre-coated steel roofing/ walling sheets	
550 Mpa	Tata bluescope, Interarch, Nippon Dendro (poly steel) Shree Precoated (Meta color)
24) Polypropylene fibers	Nina concrete, Reliance
25) Paint, primer, putty Asian,	Nerolac, ICI, Birla (putty), JK (Putty)

Signature & Seal of Contractor

26) Liquor /Melamine /PU polish	MRF, Asian, ICI, ICA
27) PVC Water stop	ArtiCables Baroda, Fixopan, Maruti.
28) Door Window Hardware,	Kich, Dorma, Haffle, Palladium, Magnum
29) Floor spring	Dorma. Mab ,Hafle, Godrej, Inox, Ozone
30) Door closer	Dorma. Yale., Hafle, Godrej, Ozone
31) Adhesives Wooden Adhesives	Fevicol, Blue coat, Araldite.
Tile adhesives & grouting material	BAL, Laticrete, Kerakoll.
32) Oil & water finish Double boiled	CAT brand linseed oil & MTO of reliance
33) Fire door	Shaktimat, AGEW, Radiant.
34) Aluminum sections	Jindal, Hindalco (Indal), Banco, Royal touch, Bhoruka, Pankaj, Alufit, Gulf extrusion.
35) Aluminum finish	
Interior works	Super durable powder coated (Akzonobel, Jotun, FullerAG)
Façade exteriors	PVDF finish (Valspar, PPG, Akzonobel)
Non visible	surface Chromatizing.
36) Aluminum Window locks, handle ,	Alualpha, Securestyle, Giessee, Roto, Geze, Savio, Frikstay
37) Rough ground for Aluminium works	IS 710 ply, 6mm to 8mm thick or Ghana teak.
38) Gasket of infill panel for Aluminum Maharashtra	Amee rubber, gold seal, Osaka rubber, polymer, Maharashtra tyre & rubber industries.
39) Anchor Fasteners	Axel, Hilti, Fischer, Kundan, Mungo, Corroshield, Buildex
40) Spandrel Insulation	Glass wool
41) Wool felt/weather strip	Anand, reddiplex ltd.
42) Rust Remover/converter	Feovert (Krishna Conchem), Roff
43) Non-shrink general purpose grout	Rust Clear (Pidilite Industries)
44) Anchoring chemical for rebar dowell bar	Fosroc, BASF
45) Roll down mosquito curtain	Hilti, Fischer, Axel
46) Baker Rod, Expansion joint pre-moulded filler board	Netmos
47) SS clamps for cladding	Supreme.
48) Aluminium operable Louvers	Hilti, Axel.
49) Spacer tape	Technal, Domal
50) Anodizing	Norton, tremco, bow.
51) Glass Processor	Bhoruka alum, Alufit alum, Ajit India, Alufin
For HS/HT, Bulletproof, DGU, Toughness, Lamination etc.	
52) Smoke seal	Impact safety, sejal, Glasstech, GSC,
53) Elevator Schindler,	Asahi, FG Glass, Goldplus, Emirates
54) uPVC windows	Intumecent Hilti/3M.
55) First Class Brick	Otis, Mitsubishi
Autoclaved Aerated Concrete Block	Kommerling, Fenesta
	Jay Jalaram Bricks, Jindal Mechno Bricks
	Aerocon, Green

Signature & Seal of Contractor

Note:

[a] Where other Material are proposed to be used these should be got approved from the Architect/Bank's Engineer before execution of particular item. In case of Non- Availability of any material of specified make, the Alternative equivalent make should be used only after it is Approved in writing by the Employer or the Architect. The Material shall be used in preferential Order only.

[b] Before starting of work, contractor must get all samples/make approved from Architect/ Bank's authorities before using at site

[c] Consultants/Bank's authorities reserve the right to add or delete name of any manufactures and when required.

[d] Consultants/Bank's authorities reserve rights to select any of the specified brands mentioned above.

Signature & Seal of Contractor

MODE OF MEASUREMENT

1. Unless otherwise stated, all pipes shall be measured net, length as laid and measured overall fittings, such as bends, junctions, etc., and given in running meters. The length shall be taken along the center line of the pipes and fittings.
1. False Ceiling shall be measured in Plan area (length x width) only; irrespective of design in vertical patta, coves, dome etc.
2. Storage/ Almirah/ Wardobes etc shall be measured in elevation area (width x height) only; irrespective of depth from 450 mm to 600 mm.
4. Length of fittings viz, taps, valves, traps etc., which are paid under appropriate items shall not be re-measured under linear measurements as enumerated above.
5. Soil waste and vent pipes shall be measured along the center line of the stack including the connecting bends/tees to W.C. Pan, Nahani trap, etc. and shall be paid as enumerated above.
6. W.C. Pans, Lavatory basins, Sinks, Drain boards, Urinals, Mirrors, Glass shelf Toilet paper Holder, shall be measured by number and shall include all accessories as enumerated in detail specification under each item.
7. Unless otherwise specified, all types of taps, valves, etc., shall be measured by number and paid separately.
8. Manholes, inspection Chambers, Gully traps, etc. shall be constructed according to detail specification and measured by number and paid separately. The depth of Manhole shall mean the vertical distance from the top of the Manhole cover to the outgoing invert of the main drain channel.
9. Water meter shall include Y strainer and other appurtenances required by the local bodies and shall include brick masonry chamber, etc., as per detailed specifications and item shall be measured by number and paid for accordingly or as per schedule of quantity.

Signature & Seal of Contractor

PREAMBLE TO SCHEDULE OF QUANTITIES

Note: While quoting rates for each item of work, the contractor shall include for the following irrespective whether it has been mentioned or not in the description of the item without any extra claim / payment.

1. All unexposed surfaces of timber (any variety) used shall be treated with necessary coats of wood preservative.
2. All exposed surfaces of timber (any variety) shall also have necessary coat of wood primer / putty and paint / polish as per description in the item.
3. Before making bulk quantities, the contractor shall make each of the item as sample and get it approved in writing from the consultant's minor modification if and as suggested by the consultant the same shall have to be incorporated without any extra cost.
4. All exposed edges of ply board shall be fixed with cedar / teak wood lipping.
5. All fabrics / leatherite to be used shall cost Rs. 300/ - per meter unless otherwise specified in the item.
Difference in cost for approved sample shall be adjusted accordingly.
6. For furniture item where required whether mentioned or not shall be include providing fixing of Brass / Power coated handles /knobs multipurpose locks, mini tower bolts, ball catchers, hinges, screws and sliding rails etc.
7. Back of all storage, cabinets, and consoles shall be in 6mm commercial ply only.
8. Thickness of laminates to be used shall be 1 mm except where specified.
9. Ant termite treatment is to provide for all wood / board /ply used in the storage.

Signature & Seal of Contractor

SME Nashik Area

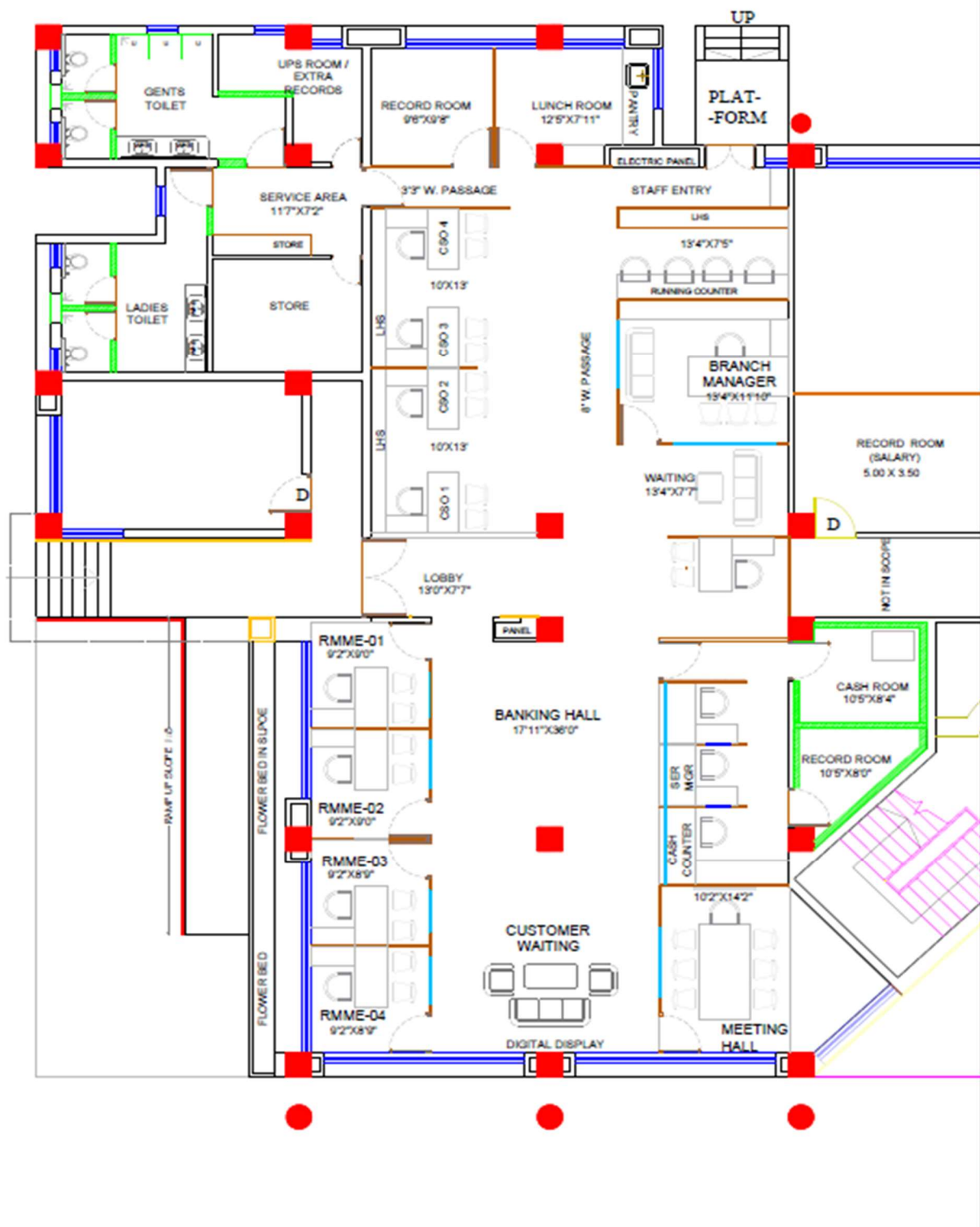

GROUND FLOOR LAYOUT

PROJECT TITLE:
PROPOSED INTERIOR PROJECT
FOR SBI, NASHIK

03/02/24



Rupali & Vivek
Jaykhedkar
Architects

45/6, Shivprasad, Old Pindli Colony, Nashik - 2
TEL: +91 203 257130/131/132 FAX: +91 203 2571330
email: rjnashik@gmail.com website: www.jaykhedkar.com